



QUICK DESIGN GUIDE AND RULES OF THUMB

CONOVEY

TABLE OF CONTENTS



CHAIN - GENERAL GUIDELINES | 3

Chain Materials | 4
Chain Structure | 5
Chain General | 6-7
Chain Dimensions | 8-10
Chain Guidelines | 11-15

CHAIN TYPES - SUPERTIGHT CHAIN | 17

25mm SuperTight Chain | 18-20
50mm SuperTight Chain | 21-22
50mm Pillow Top Chain | 23-25
Tube Top Rollers | 26-27

CHAIN TYPES - LEGACY CHAIN | 29

MultiSpan Chain | 30-32
MonoSpan Chain | 33-34
MaxiSpan Chain | 35-36

CHAIN TYPES - SPECIALTY | 37

Closed Top Chain | 38-39
MicroSpan Chain | 40
MlniLink Chain | 41-42
J-Trax Chain | 43 -44

DIRECTIONAL SECTIONS |45

Bed Sections | 46
Horizontal Curves | 47
Vertical Bends | 48
Support Structures | 49

CONVEYORS - ELEVATION CHANGE | 51

Topper Lift | 52
Outrunner Spiral | 53
Helical Curve | 54
Wedge Unit | 55-56

CONVEYORS - SORTING & MERGING | 57

Powered Divert | 58
Transpositor | 59
Vertical Switch | 60
Pushers & Squeeze Stops | 61
High Speed Switch | 62

CONVEYORS - SPECIALTY | 63

EZSpan Conveyor | 64
Twist Conveyor | 65
Endless Loop | 66

CONVEYORS - ACCUMULATION | 67

Accumulation Rules | 68 - 69

CONVEYORS - DRIVES & GEAR MOTORS | 71

Drives | 72
Intermediate Drives | 73
Hollow Shaft Gearmotor | 74
Outrunner Drive | 75
Gearmotors | 76 - 77
Gearmotor Controls | 77

CONVEYORS - ADD ONS |79

Guide Rail | 80
Side Walls | 81
Traffic Cop | 82
Bump Rotate | 83
Metal Detector Section | 84
Variable Frequency Drive | 85
Vinyl Underguarding | 85
Clean Out Holes | 86
Drip Trays | 86
Chain Washer | 86
Low Profile Idler | 87
Lane Dividers | 88
Lexan Safety Guarding | 88

CONVEYORS - TRANSFERS |89

Gravity Transfer | 90
MicroSpan Transfer | 91
WireMesh Transfer | 92
Horizontal Ballistic Transfer | 93
Offset Ballistic Transfer | 94
Dead Plate Transfer | 95
Fingers Transfer | 96

CHAIN

[GENERAL GUIDELINES]

The information that has been provided are guidelines only. This does not represent all design variations possible. For detailed or specific design requirements please contact a representative or email info@spantechllc.com.

CHAIN MATERIALS

Acetal

A thermoplastic used in making parts requiring high stiffness, low coefficient of friction, and excellent dimensional stability.

Acetal makes up 90-95 percent of the chain Span Tech builds and is used in most applications.

 **Extreme temperatures can affect the integrity of this material.**

Santoprene

Santoprene comes from the thermoplastic elastomer family of polymers used in high friction applications.

Santoprene performs very well when wet.

 **Conveyors using Santoprene chain can incline up to 25°.**

 **Santoprene works extremely well with bags, paper board, and plastic products.**

 **Recommended for all product material other than cardboard.**

 **Santoprene wears faster when running corrugated cardboard.**

Polyurethane

Polyurethane is a polymer with a semi transparent look.

It is the most abrasion resistant material Span Tech uses.

 **Recommended for cardboard and other abrasive products and has longer wear than Santoprene.**

 **When using Polyurethane chain, conveyors can incline up to 25°.**

Polypropylene

A thermoplastic polymer that is only offered in some MultiSpan Chain types.

 **All the center links in 50mm SuperTight chain are made of polypropylene.**

 **Can handle temperatures of 160° to -10° Fahrenheit.**

 **Polypropylene is favored in applications where chain will come in contact with chemicals that have a high Ph level and do not react well with Acetal.**

NOTES:

The information that has been provided are guidelines only. This does not represent all design variations possible. For detailed or specific design requirements please contact a representative or email info@spantechllc.com.

CHAIN STRUCTURE

Square Matrix Design

Span Tech builds its chain on a square matrix. The square matrix allows for fewer parts and chain that can be repaired or replaced in a very short amount of time.

Copy Exact

All chain rods made by Span Tech are identical from one day to the next, from one year to the next. A replacement rod bought 10 years after the sale of the system will be an exact match to the original.

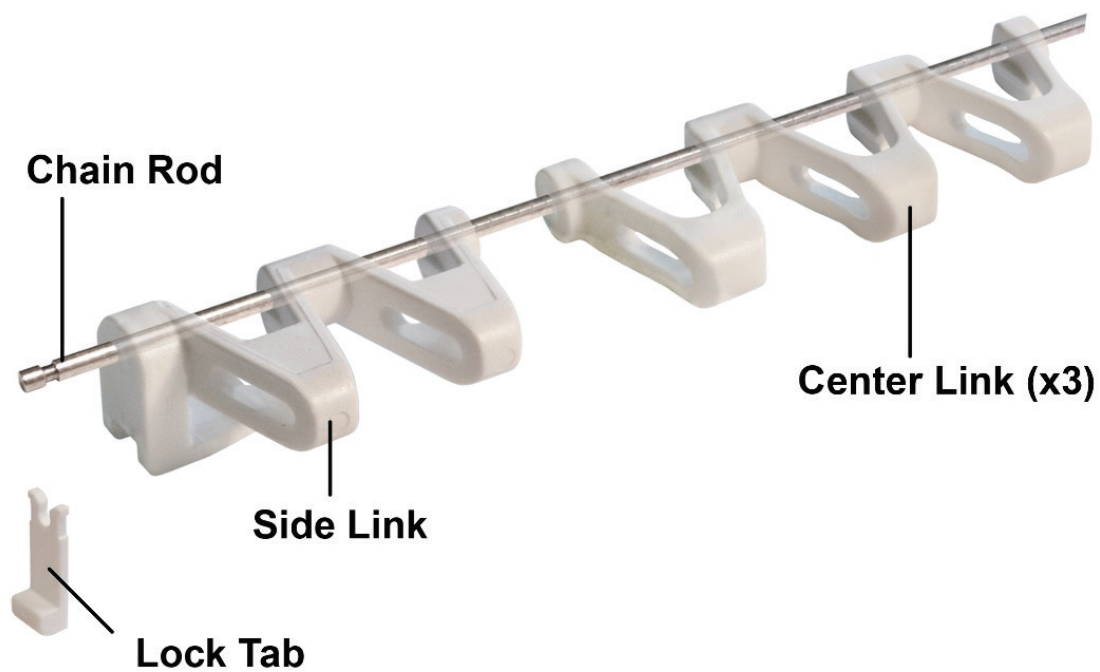

The information that has been provided are guidelines only. This does not represent all design variations possible. For detailed or specific design requirements please contact a representative or email info@spantechllc.com.

CHAIN GENERAL

As a rule of thumb, there are four basic types of product movement on a conveyor:

- 1. Product Transport**
- 2. Product Incline**
- 3. Product Decline**
- 4. Product Accumulation**

The following guidelines will assist in designing the proper chain options for various applications.

Plain Chain [1A]

Span Tech's plain chain is used for typical product transportation. Plain chain is also ideal for applications requiring accumulation because of its edgeless design. Guide rails are added to retain the product while in accumulation. Most products will normally incline up a grade of 5° and decline down a grade of 7°. When steeper angles are necessary, high friction chain should be used.

Pillow Top [1B]

Pillow Top is a perfect application for food production facilities. The innovative Pillow Top design allows the conveyor to sit as close to the transfer unit as possible. This results in successful transferring of very small products which could otherwise get caught or snagged in more traditional transfers.

👍 Pillow Top chain conveyors handle the most delicate products with ease and precision while offering a very tight turning radius for the chain width.

Moving Side Guides [1C]

Moving side guides, which are molded to the left and right side links, move along with the conveyor providing positive retention of products during transportation. Moving side guides also work extremely well with products that move in mass flow, like frozen sausage balls.

👍 Product accumulation cannot occur when moving side guides are used.

👍 Product side to side transfers can not occur when moving side guides are used.

Raised Top Chain [1D]

Span Tech's raised top chain is typically used with finger transfer plates when conveyor end to end transfer of a product is necessary. Raised top chain can also be used to reduce the amount of contact between the chain and product.

Closed Top Chain [1E]

Sometimes you need a conveyor chain with a smooth, closed carrying surface. With no open areas, Closed Top chain adds a measure of safety perfect for operator stations. Closed Top chain has an internal roller which results in extremely low running friction. This means you have the option of creating extra long conveyors of 100' or more.

👍 Closed top conveyors are straight running, but can carry heavier products due to its robust design.

Accumulation Chain [1F & 2F]

The accumulation chain option is essential for products requiring low back pressure. Back pressure is reduced by approximately 1/2 eliminating chain product damage.

👍 Products can incline or decline up to 2° when using accumulation chain patterns.

👍 Roller chain patterns require plain acetal links to interface with the drive sprockets for pulling the chain around the conveyor.

High Friction Chain [1G]

If a product must be inclined or declined at grades steeper than plain chain will accommodate, a higher friction chain is needed. Since Span Tech chain is modular, the center links can be made of a high friction material. As a rule of thumb, high friction links can incline or decline products a maximum of 25° depending on the products coefficient of friction.

👍 Product accumulation cannot occur when using high friction chain.

👍 High friction chain patterns require plain acetal links to interface with the drive sprockets for pulling the chain around the conveyor

Cleated Chain [1H]

When it is necessary to elevate or lower products at angles greater than the maximum of 25° provided by high friction chain, cleated chain should be used.

The information that has been provided are guidelines only. This does not represent all design variations possible. For detailed or specific design requirements please contact a representative or email info@spantechllc.com.

CHAIN GENERAL



[1A]

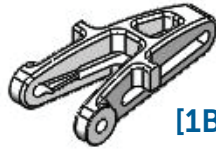

[1B]



[1C]

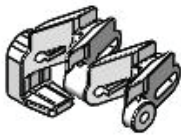

[1D]

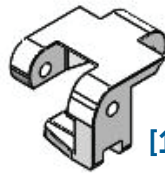

[1E]



[1F]

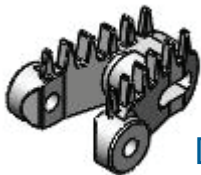

[1G]

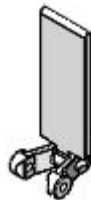

[1H]



[2F]

The information that has been provided are guidelines only. This does not represent all design variations possible. For detailed or specific design requirements please contact a representative or email info@spantechllc.com.

CHAIN DIMENSIONS

The following illustrations are plan views of chain for each conveyor type within the Span Tech family of conveyors. The dimensions shown represent basic openings for each particular type of chain.

Please use the following rules when determining product size limitations for general transport and accumulate functions for each of the conveyor types within the Span Tech family.

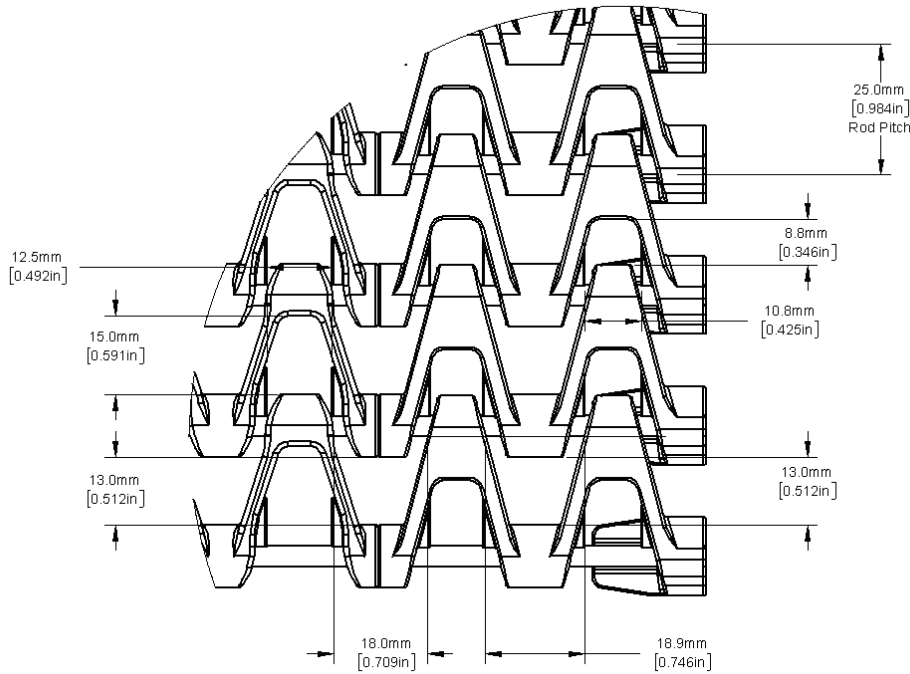

25mm SuperTight

👍 25mm SuperTight Plain Chain
Smallest Product Limitation
≥1.0" (25.4mm) Dia.

👍 25mm SuperTight Raised Top
Chain Smallest Product Limitation
≥1.125" (28.58mm) Dia.

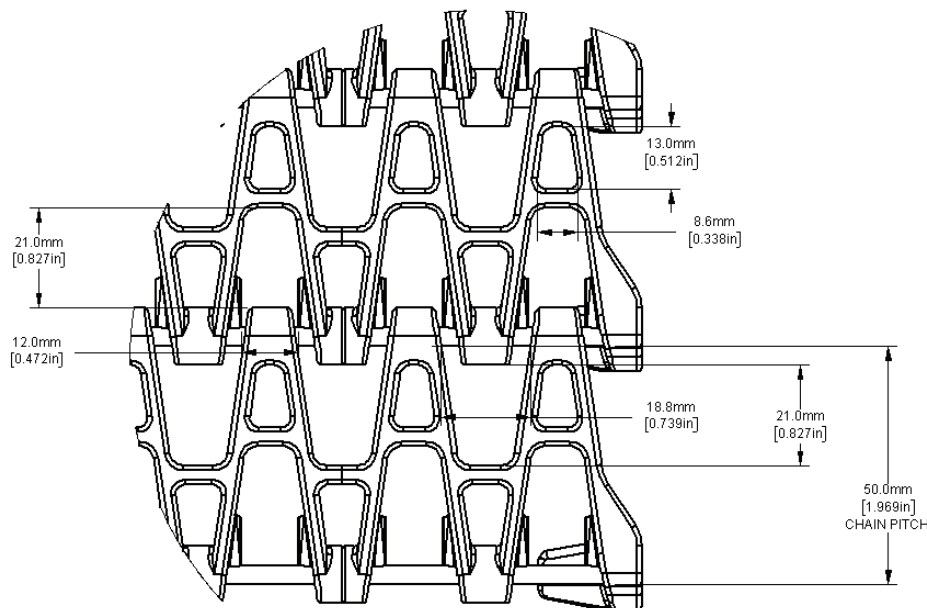

50mm SuperTight

👍 50mm SuperTight Plain Chain
Smallest Product Limitation
≥1.0" (25.4mm) Dia.

👍 50mm Super Tight Raised Top
Chain Smallest Product Limitation
≥1.75" (44.45mm) Dia.

The information that has been provided are guidelines only. This does not represent all design variations possible. For detailed or specific design requirements please contact a representative or email info@spantechllc.com.

50mm Pillow Top

👍 **50mm Pillow Top Plain Chain**
Smallest Product Limitation
 $\geq 1.0''$ (25.4mm) Dia.

👍 **50mm Pillow Top Raised Top Chain**
Smallest Product Limitation
 $\geq 1.75''$ (44.45mm) Dia.

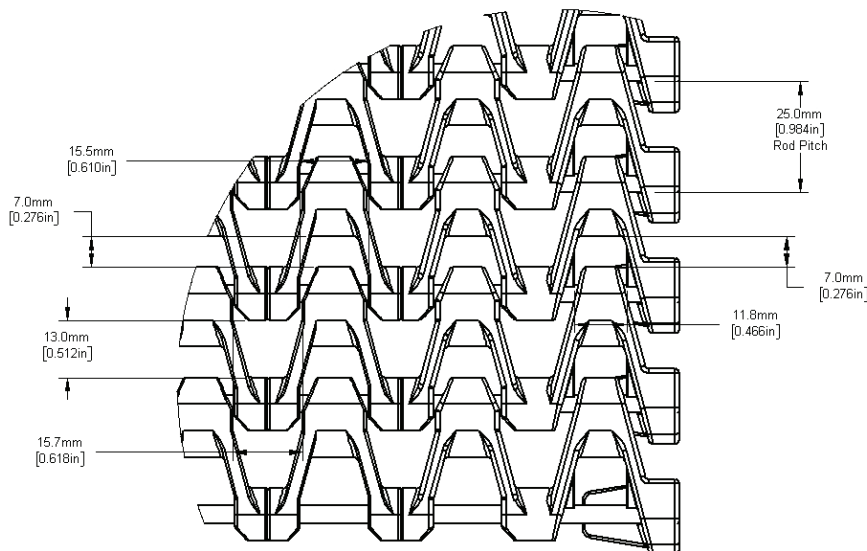
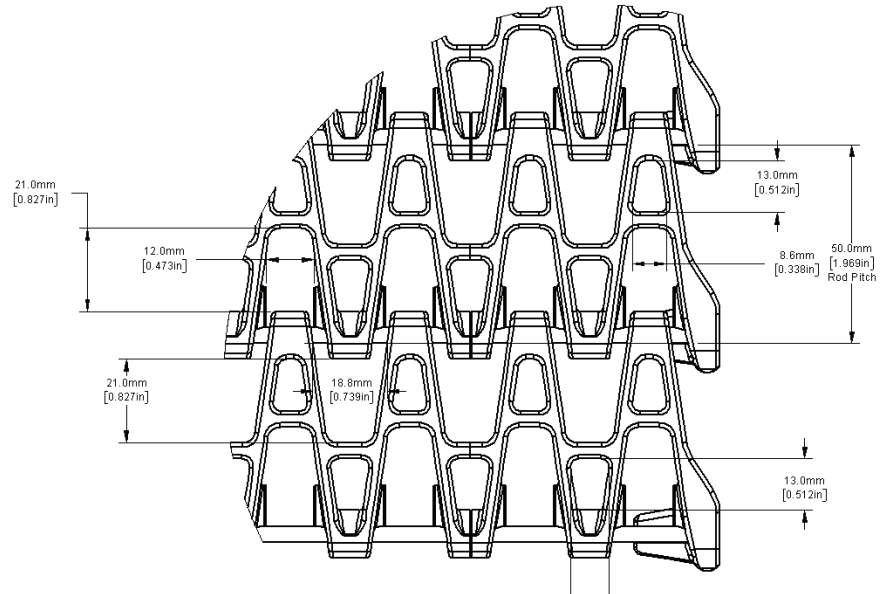

25mm MultiSpan

👍 **MultiSpan Plain Chain**
Smallest Product Limitation
 $\geq 1.0''$ (25.4mm) Dia.

👍 **MultiSpan Raised Top Chain**
Smallest Product Limitation
 $\geq 1.125''$ (28.58mm) Dia.

The information that has been provided are guidelines only. This does not represent all design variations possible. For detailed or specific design requirements please contact a representative or email info@spantechllc.com.

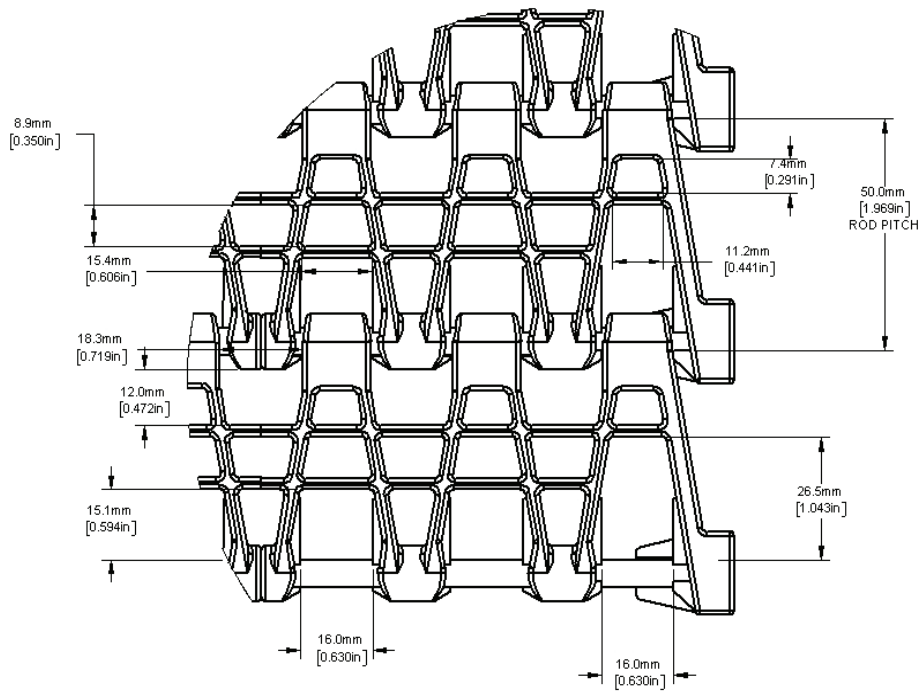

50mm MaxiSpan

👍 **MaxiSpan Plain Chain**
Smallest Product Limitation
≥1.0" (25.4mm) Dia.

👍 **MaxiSpan Raised Top Chain**
Smallest Product Limitation
≥1.75" (44.45mm) Dia.

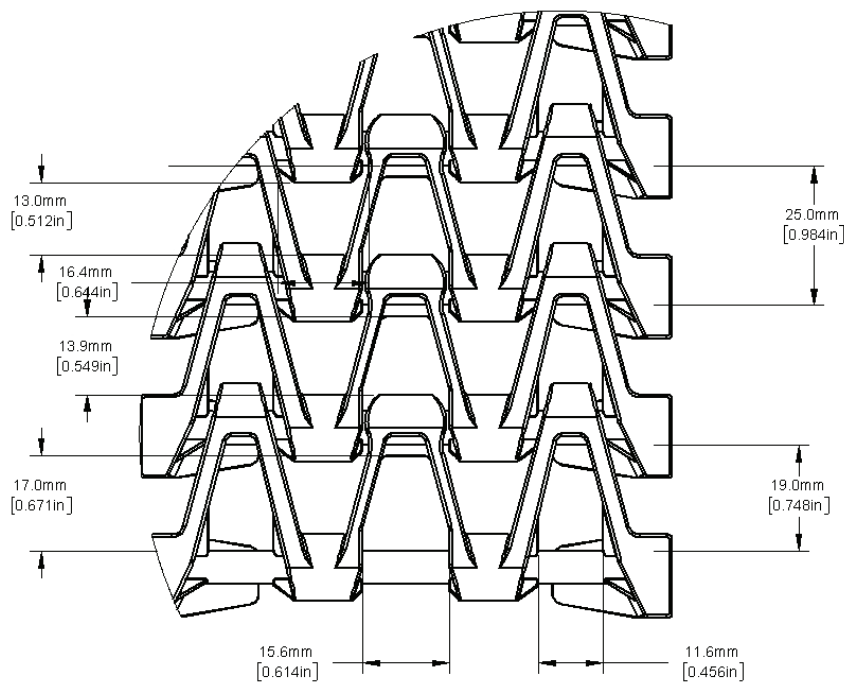

25mm MonoSpan

👍 **MonoSpan Plain Chain**
Smallest Product Limitation
≥1.0" (25.4mm) Dia or Sq.

👍 **MonoSpan Raised Top Chain**
Smallest Product Limitation
≥1.125" (28.58mm) Dia.

standard width
3.76" (95.6mm)

The information that has been provided are guidelines only. This does not represent all design variations possible. For detailed or specific design requirements please contact a representative or email info@spantechllc.com.

CHAIN GUIDELINES

The absolute minimum centerline turning radius for any of Span Tech conveyors is 18.0" (457.20mm) for aluminum framing and 21.0" (533.40mm) for stainless steel framing.

Chain Width inches	Chain Width MM	No. of Sprockets	Chain Support Rails Top	Chain Support Rails Return	Horizontal Bend Centerline Radius Aluminum (Inches)	Horizontal Bend Centerline Radius Stainless Steel (Inches)	Helical Bend Centerline Radius (Inches)
3.76	95.6	1	0	0	18	21	33.88
4.94	125.6	2	0	0	18	21	34.47
6.13	155.6	2	0	0	18	21	35.06
7.31	185.6	2	0	0	18	21	35.65
8.49	215.6	2	0	0	18	21	36.24
9.67	245.6	2	0	0	19.50	21	36.83
10.85	275.6	2	0	0	22.21	22.21	37.43
12.03	305.6	3	0	0	24.91	24.91	38.02
13.21	335.6	3	1	0	27.61	27.61	38.61
14.39	365.6	3	1	0	30.31	30.31	39.20
15.57	395.6	3	1	0	33.02	33.02	39.79
16.76	425.6	3	1	0	35.74	35.74	40.38
17.94	455.6	4	2	0	38.44	38.44	40.97
19.12	485.6	4	2	0	41.15	41.15	41.56
20.30	515.6	4	2	0	43.85	43.85	43.85
21.48	545.6	5	3	0	46.55	46.55	46.55
22.66	575.6	5	3	0	49.25	49.25	49.25
23.84	605.6	5	3	0	51.95	51.95	51.95
25.02	635.6	5	3	1	54.66	54.66	54.66
26.20	665.6	5	3	1	57.36	57.36	57.36
27.39	695.6	5	3	1	60.08	60.08	60.08
28.57	725.6	5	3	1	62.79	62.79	62.79
29.75	755.6	5	3	1	65.49	65.49	65.49
30.93	785.6	5	3	1	68.19	68.19	68.19
32.11	815.6	5	3	1	70.89	70.89	70.89
33.29	845.6	6	4	1	73.59	73.59	73.59
34.47	875.6	6	4	1	76.30	76.30	76.30
35.65	905.6	6	4	1	79.00	79.00	79.00
36.83	935.6	6	4	1	81.70	81.70	81.70
38.02	965.6	7	5	1	84.43	84.43	84.43
39.20	995.6	7	5	1	87.13	87.13	87.13
40.38	1025.6	7	5	1	89.83	89.83	89.83
41.56	1055.6	7	5	1	92.53	92.53	92.53
42.74	1085.6	7	5	1	95.24	95.24	95.24
43.92	1115.6	7	5	1	97.94	97.94	97.94
45.10	1145.6	7	5	1	100.64	100.64	100.64
46.28	1175.6	7	5	1	103.34	103.34	103.34
47.46	1205.6	8	6	2	106.04	106.04	106.04

25mm SuperTight Centerline Bend Radius = CW * 2.29 - 2.64"

25MM SUPERTIGHT

The information that has been provided are guidelines only. This does not represent all design variations possible. For detailed or specific design requirements please contact a representative or email info@spantechllc.com.

Chain Width inches	Chain Width MM	No. of Sprockets	Chain Support Rails Top	Chain Support Rails Return	Horizontal Bend Centerline Radius Aluminum (Inches)	Horizontal Bend Centerline Radius Stainless Steel (Inches)	Helical Bend Centerline Radius (Inches)
3.76	95.6	1	0	0	18	21	33.88
4.94	125.6	2	0	0	18	21	34.47
6.13	155.6	2	0	0	18	21	35.06
7.31	185.6	2	0	0	18	21	35.65
8.49	215.6	2	0	0	18	21	36.24
9.67	245.6	2	0	0	18.66	21	36.83
10.85	275.6	2	0	0	20.94	21	37.43
12.03	305.6	3	0	0	23.22	23.22	38.02
13.21	335.6	3	1	0	25.50	25.50	38.61
14.39	365.6	3	1	0	27.77	27.77	39.20
15.57	395.6	3	1	0	30.05	30.05	39.79
16.76	425.6	3	1	0	32.35	32.35	40.38
17.94	455.6	4	2	0	34.62	34.62	40.97
19.12	485.6	4	2	0	36.90	36.90	41.56
20.30	515.6	4	2	0	39.18	39.18	42.15
21.48	545.6	5	3	0	41.46	41.46	42.74
22.66	575.6	5	3	0	43.73	43.73	43.33
23.84	605.6	5	3	0	46.01	46.01	43.92
25.02	635.6	5	3	1	48.29	48.29	45.66
26.20	665.6	5	3	1	50.57	50.57	47.94
27.39	695.6	5	3	1	52.86	52.86	52.86
28.57	725.6	5	3	1	55.14	55.14	55.14
29.75	755.6	5	3	1	57.42	57.42	57.42
30.93	785.6	5	3	1	59.70	59.70	59.70
32.11	815.6	5	3	1	61.97	61.97	61.97
33.29	845.6	6	4	1	64.25	64.25	64.25
34.47	875.6	6	4	1	66.53	66.53	66.53
35.65	905.6	6	4	1	68.81	68.81	68.81
36.83	935.6	6	4	1	71.08	71.08	71.08
38.02	965.6	7	5	1	73.38	73.38	73.38
39.20	995.6	7	5	1	75.66	75.66	75.66
40.38	1025.6	7	5	1	77.93	77.93	77.93
41.56	1055.6	7	5	1	80.21	80.21	80.21
42.74	1085.6	7	5	1	82.49	82.49	82.49
43.92	1115.6	7	5	1	84.77	84.77	84.77
45.10	1145.6	7	5	1	87.04	87.04	87.04
46.28	1175.6	7	5	1	89.32	89.32	89.32
47.46	1205.6	8	6	2	91.60	91.60	91.60
50mm SuperTight Centerline Bend Radius = CW * 1.93							

50MM SUPERTIGHT

The information that has been provided are guidelines only. This does not represent all design variations possible. For detailed or specific design requirements please contact a representative or email info@spantechllc.com.

Chain Width inches	Chain Width MM	No. of Sprockets	Chain Support Rails Top	Chain Support Rails Return
3.76	95.6	1	0	0
4.94	125.6	2	0	0
6.13	155.6	2	0	0
7.31	185.6	2	0	0
8.49	215.6	2	0	0
9.67	245.6	2	0	0
10.85	275.6	2	0	0
12.03	305.6	3	0	0
13.21	335.6	3	1	0
14.39	365.6	3	1	0
15.57	395.6	3	1	0
16.76	425.6	3	1	0
17.94	455.6	4	2	0
19.12	485.6	4	2	0
20.30	515.6	4	2	0
21.48	545.6	5	3	0
22.66	575.6	5	3	0
23.84	605.6	5	3	0
25.02	635.6	5	3	1
26.20	665.6	5	3	1
27.39	695.6	5	3	1
28.57	725.6	5	3	1
29.75	755.6	5	3	1
30.93	785.6	5	3	1
32.11	815.6	5	3	1
33.29	845.6	6	4	1
34.47	875.6	6	4	1
35.65	905.6	6	4	1
36.83	935.6	6	4	1
38.02	965.6	7	5	1
39.20	995.6	7	5	1
40.38	1025.6	7	5	1
41.56	1055.6	7	5	1
42.74	1085.6	7	5	1
43.92	1115.6	7	5	1
45.10	1145.6	7	5	1
46.28	1175.6	7	5	1

CLOSED TOP

The information that has been provided are guidelines only. This does not represent all design variations possible. For detailed or specific design requirements please contact a representative or email info@spantechllc.com.

Chain Width inches	Chain Width MM	No. of Sprockets	Chain Support Rails Top	Chain Support Rails Return	Horizontal Bend Centerline Radius Aluminum (Inches)	Horizontal Bend Centerline Radius Stainless Steel (Inches)	Helical Bend Centerline Radius (Inches)
3.76	95.6	1	0	0	18	21	33.88
4.94	125.6	2	0	0	18	21	34.47
6.13	155.6	2	0	0	19.12	21	35.06
7.31	185.6	2	0	0	22.80	22.80	35.65
8.49	215.6	2	0	0	26.48	26.48	36.24
9.67	245.6	2	0	0	30.17	30.17	36.83
10.85	275.6	2	0	0	33.85	33.85	37.43
12.03	305.6	3	0	0	37.53	37.53	38.02
13.21	335.6	3	1	0	41.22	41.22	41.22
14.39	365.6	3	1	0	44.90	44.90	44.90
15.57	395.6	3	1	0	48.58	48.58	48.58
16.76	425.6	3	1	0	52.29	52.29	52.29
17.94	455.6	4	2	0	55.97	55.97	55.97
19.12	485.6	4	2	0	59.65	59.65	59.65
20.30	515.6	4	2	0	63.33	63.33	63.33
21.48	545.6	5	3	0	67.02	67.02	67.02
22.66	575.6	5	3	0	70.70	70.70	70.70
23.84	605.6	5	3	0	74.38	74.38	74.38
25.02	635.6	5	3	1	78.06	78.06	78.06
26.20	665.6	5	3	1	81.74	81.74	81.74
27.39	695.6	5	3	1	85.46	85.46	85.46
28.57	725.6	5	3	1	89.14	89.14	89.14
29.75	755.6	5	3	1	92.82	92.82	92.82
30.93	785.6	5	3	1	96.5	96.5	96.5
32.11	815.6	5	3	1	100.18	100.18	100.18
33.29	845.6	6	4	1	103.87	103.87	103.87
34.47	875.6	6	4	1	107.55	107.55	107.55
35.65	905.6	6	4	1	111.23	111.23	111.23
36.83	935.6	6	4	1	114.91	114.91	114.91
38.02	965.6	7	5	1	118.62	118.62	118.62
39.20	995.6	7	5	1	122.30	122.30	122.30
40.38	1025.6	7	5	1	125.99	125.99	125.99
41.56	1055.6	7	5	1	129.67	129.67	129.67
42.74	1085.6	7	5	1	133.35	133.35	133.35
43.92	1115.6	7	5	1	137.03	137.03	137.03
45.10	1145.6	7	5	1	140.71	140.71	140.71
46.28	1175.6	7	5	1	144.39	144.39	144.39
47.46	1205.6	8	6	2	148.08	148.08	148.08
MultiSpan Centerline Bend Radius = CW*3.12							

MULTISPAN

The information that has been provided are guidelines only. This does not represent all design variations possible. For detailed or specific design requirements please contact a representative or email info@spantechllc.com.

Chain Width inches	Chain Width MM	No. of Sprockets	Chain Support Rails Top	Chain Support Rails Return	Horizontal Bend Centerline Radius Aluminum (Inches)	Horizontal Bend Centerline Radius Stainless Steel (Inches)
8.24	209.2	2	2	0	21.75	21.75
12.17	309.2	3	3	0	35.45	35.45
16.11	409.2	4	4	0	49.15	49.15
20.05	509.2	5	5	0	62.85	62.85
23.98	609.2	6	6	1	76.56	76.56
27.92	709.2	7	7	1	90.26	90.26
31.86	809.2	8	8	1	103.96	103.96
35.80	909.2	9	9	1	117.66	117.66
39.73	1009.2	10	10	1	131.36	131.36
43.67	1109.2	11	11	1	145.06	145.06
47.61	1209.2	12	12	1	158.76	158.76

MAXISPAN

Chain Width inches	Chain Width MM	No. of Sprockets	Chain Support Rails Top	Chain Support Rails Return	Horizontal Bend Centerline Radius Aluminum (Inches)	Horizontal Bend Centerline Radius Stainless Steel (Inches)
3.76	95.6	1	0	0	21	21
7.53	191.26	2	0	0	23.49	23.49
11.29	286.77	2	0	0	35.22	35.22
15.06	382.52	2	0	0	46.99	46.99

MonoSpan is a fixed width of 3.76" when requiring a wider width conveying surface multiple chain modules are used.

MONOSPAN

The information that has been provided are guidelines only. This does not represent all design variations possible. For detailed or specific design requirements please contact a representative or email info@spantechllc.com.

CHAIN TYPES

[SUPERTIGHT CHAIN]

The information that has been provided are guidelines only. This does not represent all design variations possible. For detailed or specific design requirements please contact a representative or email info@spantechllc.com.

25MM SUPERTIGHT CHAIN

Light, economical chain for many of your standard applications.

Material Options

Available in acetal, santoprene & polyurethane.

Tight Turning Radius

SuperTight Chain has a tighter horizontal bend radius than MultiSpan.

25mm SuperTight Centerline Radius Formula
Chain Width * 2.29-2.64"

Durable

SuperTight Chain is very lightweight yet very strong.

Sanitary

The open design concept improves cleanability.

Cost Effective

SuperTight Chain has all the versatility of regular MultiSpan Chain but more cost effective.

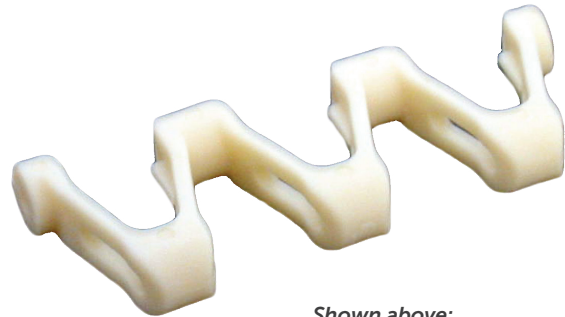

Shown above:
DS-C-ST-PL-2-S
PLAIN CENTER SANTOPRENE
3 LINK

SPECIFICATIONS FOR 25MM SUPERTIGHT CHAIN

- SuperTight Chain has a weight of 1.9 lbs/ft² and has a load carrying capacity of 50 lbs/ft². SuperTight Chain is connected by 4mm diameter stainless or mild steel connecting rods and plastic chain lock tabs.

- Santoprene material is ideal for glossy, finished or printed cardboard, plastic containers or metal.

CHAIN OPTIONS:

- Plain (White or Blue)
- 6mm Raised Top
- 6mm Moving Side Guide
- 30mm Moving Side Guide
- 75mm Moving Side Guide
- Plain High Friction
- 6mm Raised Top High Friction
- 6mm Brush Top High Friction
- 10mm Brush Top High Friction

PITCH

- 25mm (0.98")

AVAILABLE WIDTH RANGE

- 95.5mm - 1205.48mm (3.76" - 47.46")

NOTES:

The information that has been provided are guidelines only. This does not represent all design variations possible. For detailed or specific design requirements please contact a representative or email info@spantechllc.com.

ACETAL LINKS

KEY: LH = LEFT HAND • RH = RIGHT HAND • MSG = MOVING SIDE GUIDE • (PU) = POLYURETHANE • (S) = SANTOPRENE • (A) = ACETAL

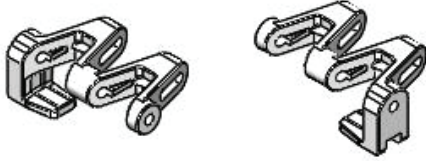

DS0126-02A - LEFT HAND PLAIN
DS0127-02A - RIGHT HAND PLAIN

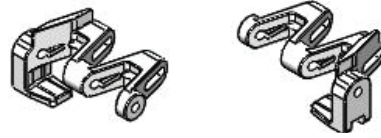

DS0128-03A - LH MSG 6MM
DS0129-03A - RH MSG 6MM

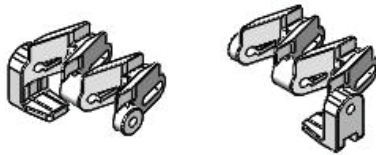

DS0132-02A - LH RAISED 6MM
DS0133-02A - RH RAISED 6MM

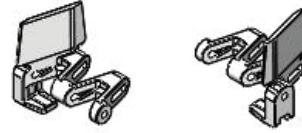

DS0136-01A-30 - LH 30MM MSG
DS0137-01A-30 - RH 30MM MSG



DS0136-01A - LH 75MM MSG
DS0137-01A - RH 75MM MSG

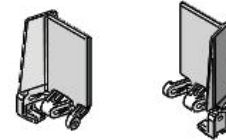

DS0138-01A - LH 75MM MSG/PUSHER
DS0139-01A - RH 75MM MSG/PUSHER



DS-C-ST-PL-1-A
PLAIN CENTER
1 LINK

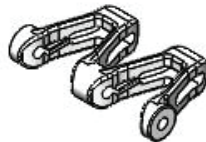

DS-C-ST-PL-2-A
PLAIN CENTER
2 LINK

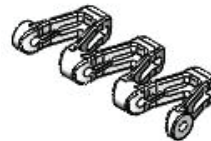

DS-C-ST-PL-3-A
PLAIN CENTER
3 LINK



DS0134-02A
PLAIN CENTER
7 LINK

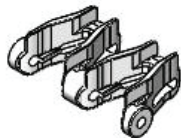

DS C ST 6MM RT 2 A
6 MM RAISED CENTER
2 LINK

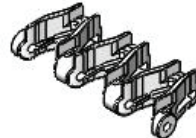

DS C ST 6MM RT 3 A
6MM RAISED CENTER
3 LINK



DS0135-02A
6MM RAISED CENTER
7 LINK

The information that has been provided are guidelines only. This does not represent all design variations possible. For detailed or specific design requirements please contact a representative or email info@spantechllc.com.

SANTOPRENE & POLYURETHANE LINKS

[HIGH FRICTION]

KEY: LH = LEFT HAND • RH = RIGHT HAND • MSG = MOVING SIDE GUIDE • (PU) = POLYURETHANE • (S) = SANTOPRENE • (A) = ACETAL

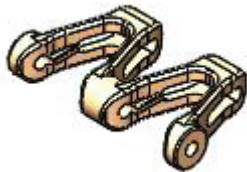

DS-C-ST-PL-2-S
PLAIN CENTER
2 LINK



DS-C-ST-6MM-BT-2-S
6MM BRUSH TOP
2 LINK

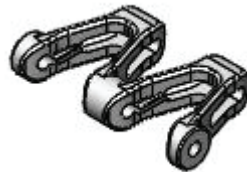

DS-C-ST-PL-2-PU
PLAIN CENTER
2 LINK



DS-C-ST-6MM-BT-2-PU
6MM BRUSH TOP
2 LINK

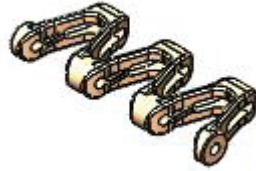

DS-C-ST-PL-3-S
PLAIN CENTER
3 LINK



DS-C-ST-6MM-BT-3-S
6MM BRUSH TOP
3 LINK



DS-C-ST-PL-3-PU
PLAIN CENTER
3 LINK



DS-C-ST-6MM-BT-3-PU
6MM BRUSH TOP
3 LINK



DS-C-ST-6MM-RT-2-S
6MM RAISED
2 LINK



DS-C-ST-10MM-BT-2-S
10MM BRUSH TOP
2 LINK



DS-C-ST-6MM-RT-2-PU
6MM RAISED
2 LINK



DS-C-ST-10MM-BT-2-PU
10MM BRUSH TOP
2 LINK

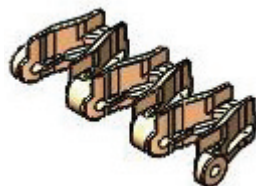

DS-C-ST-6MM-RT-3-S
6MM RAISED
3 LINK



DS-C-ST-10MM-BT-3-S
10MM BRUSH TOP
3 LINK

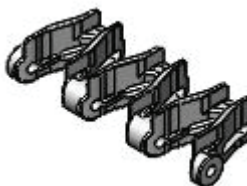

DS-C-ST-6MM-RT-3-PU
6MM RAISED
3 LINK



DS-C-ST-10MM-BT-3-PU
10MM BRUSH TOP
3 LINK

The information that has been provided are guidelines only. This does not represent all design variations possible. For detailed or specific design requirements please contact a representative or email info@spantechllc.com.

50MM SUPERTIGHT CHAIN

Perfect solution for applications where a low-cost, high performance conveyor is needed.

Material Options

Acetal side links and polypropylene center links.

Tight Turning Radius

50mm SuperTight chain has the tightest turning radius that Span Tech offers.

Durable

50mm SuperTight chain is very lightweight yet very strong.

Sanitary

The open design concept improves cleanability.

Cost Effective

50mm SuperTight chain uses half the number of rods making it more cost effective than our 25mm pitch chains.

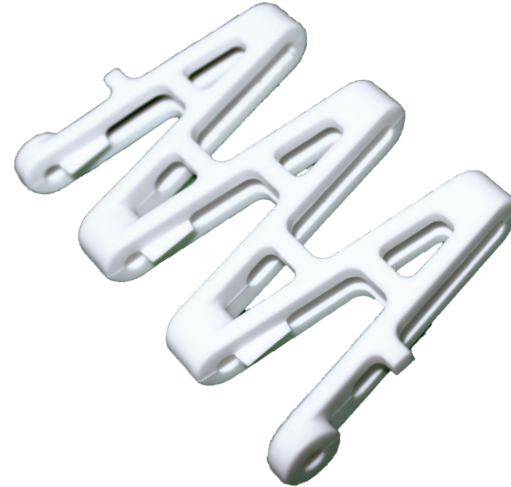

Shown above:
DS0011P-3V
PLAIN CENTER
3 LINK

SPECIFICATIONS FOR 50MM SUPERTIGHT CHAIN

- 50mm SuperTight chain has an open rod design allowing for good airflow, thus making it perfect for cooling or drying applications.
- 50mm SuperTight chain is a perfect fit for food & beverage production, packaging, & e-commerce.

CHAIN OPTIONS:

- Plain (White or Blue)

PITCH

- 50mm (1.97")

AVAILABLE WIDTH RANGE

- 95.5mm - 1205.48mm (3.76" - 46.28")

NOTES:

The information that has been provided are guidelines only. This does not represent all design variations possible. For detailed or specific design requirements please contact a representative or email info@spantechllc.com.

ACETAL & POLYPROPYLENE LINKS

KEY: LH = LEFT HAND • RH = RIGHT HAND • MSG = MOVING SIDE GUIDE • (PU) = POLYURETHANE • (S) = SANTOPRENE • (A) = ACETAL

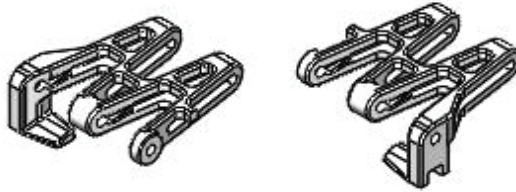

DS0142A - LEFT HAND PLAIN
DS0143A- RIGHT HAND PLAIN

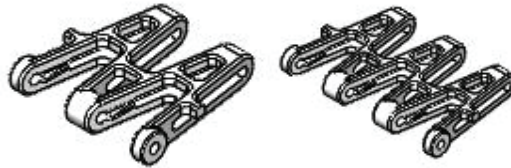

DS0011P-2V - PLAIN CENTER 2/8
DS0011P-3V - PLAIN CENTER 3/8



DS0011P-7M - PLAIN CENTER

The information that has been provided are guidelines only. This does not represent all design variations possible. For detailed or specific design requirements please contact a representative or email info@spantechllc.com.

50MM PILLOWTOP CHAIN

Handles the most delicate of products with ease and precision.

Material Options

Acetal, santoprene, & polyurethane

Tight Turning Radius

50mm PillowTop chain has one of the tighter turning radii that Span Tech offers.

Durable

50mm PillowTop Chain is very lightweight yet very strong.

Sanitary

The open design concept improves cleanability and makes it perfect for cooling applications.

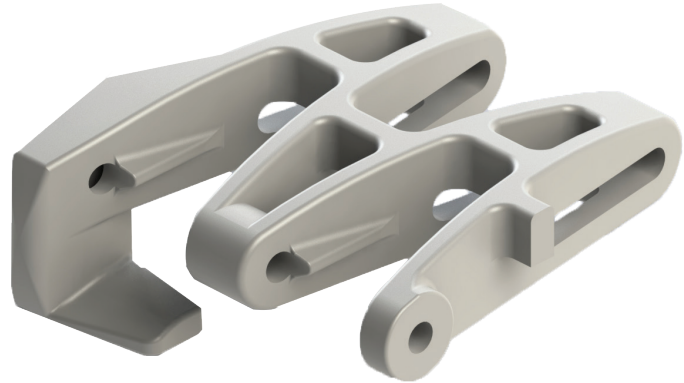

Shown above:
DS0160A
50MM PILLOW TOP LH PLAIN

SPECIFICATIONS FOR 50MM PILLOWTOP CHAIN

- 50mm PillowTop chain has a curved design which significantly reduces chordal action allowing transfers to be positioned extremely close to the chain. This makes Pillow Top chain a good fit for food industries especially thin products such as tortillas and cookies.
- 50mm PillowTop chain paired with a dead plate transfer allows for a more cost effective method of transferring small products.
- PillowTop chain can easily replace any 50mm SuperTight chain.

CHAIN OPTIONS:

- Plain (White or Blue)
- Moving Side Guide (White or Blue)
- Santoprene High Friction
- Polyurethane High Friction

PITCH

- 50mm (1.97")

AVAILABLE WIDTH RANGE

- 95.6mm - 1205.6mm (3.76" - 46.28")

NOTES:

The information that has been provided are guidelines only. This does not represent all design variations possible. For detailed or specific design requirements please contact a representative or email info@spantechllc.com.

WHAT IS CHORDAL ACTION?

The rising and lowering of an individual chain link as it enters a sprocket is known as chordal action. The reason it happens is simply due to geometry. When a chain is “wrapped” around a sprocket, the pins of the chain form a polygon shape. When you look at this polygon shape traveling around a sprocket, it is bumpy – not smooth. When a conveyor chain enters a drive sprocket, it goes from a flat line to this polygon shape and results in a rise/lowering of the pin. This effect can be lessened only by using a smaller pitch chain, or increasing the sprocket size – it cannot be prevented. That being said, depending on the elevation of the chain (in relation to the sprocket), we can control whether the chain “rises” or “lowers” to match this polygon shape.

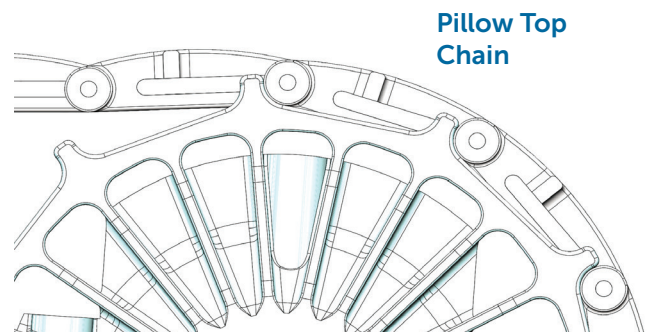
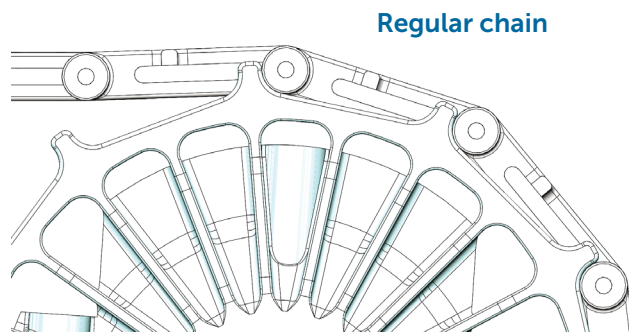

ACETAL SANTOPRENE & POLYURETHANE LINKS

KEY: LH = LEFT HAND • RH = RIGHT HAND • MSG = MOVING SIDE GUIDE • (PU) = POLYURETHANE • (S) = SANTOPRENE • (A) = ACETAL

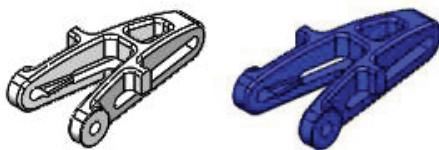

DS0162A-1V - 50MM CENTER PLAIN
DS0162A-1V - 50MM CENTER BLUE



DS0162A-2V - 50MM CENTER 2C PLAIN
DS0162A-2V - 50MM CENTER 2C BLUE



DS0162S-2V - 50 MM PILLOW TOP 2C (S)
DS0162PU-2V - 50MM PILLOW TOP 2C (P)



DS0162S-3V - 50MM 3C (S)
DS0162PU-3V - 50 MM 3C (P)

The information that has been provided are guidelines only. This does not represent all design variations possible. For detailed or specific design requirements please contact a representative or email info@spantechllc.com.

ACETAL SANTOPRENE & POLYURETHANE LINKS

KEY: LH = LEFT HAND • RH = RIGHT HAND • MSG = MOVING SIDE GUIDE • (PU) = POLYURETHANE • (S) = SANTOPRENE • (A) = ACETAL

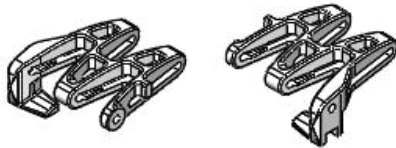

DS0160A - 50MM LH PLAIN
DS0161A- 50MM RH PLAIN



DS0160A-BLUE - 50MM LH
DS0161A-BLUE - 50MM RH

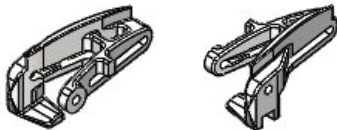

DS0163A-1/2 - 50MM LH 6MM MSG 1/2
DS0164A-1/2 - 50MM RH 6MM MSG 1/2

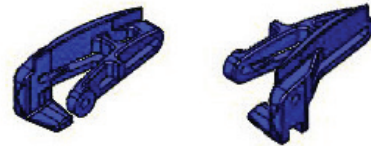

DS0163A-1/2-BLUE - 50MM LH 6MM MSG 1/2
DS0164A-1/2-BLUE - 50MM RH 6MM MSG 1/2

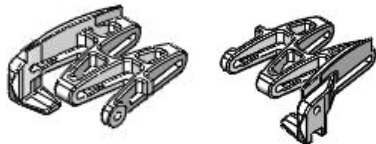

DS0163A - 50MM LH 6MM MSG
DS0164A - 50MM 6MM MSG

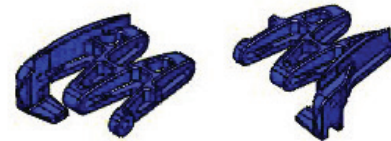

DS0163A-BLUE - 50MM LH 6MM MSG
DS0164A-BLUE - 50MM RH 6MM MSG



DS0162A - 50MM CENTER 8C PLAIN
DS0162A-BLUE - 50MM CENTER 8C BLUE

The information that has been provided are guidelines only. This does not represent all design variations possible. For detailed or specific design requirements please contact a representative or email info@spantechllc.com.

TUBE TOP ROLLER

Used in applications where the product needs to accumulate.

Reduced Back Pressure

TubeTop Rollers reduce back pressure allowing products to accumulate easily without damage.

Durable

TubeTop Rollers are very lightweight yet durable.

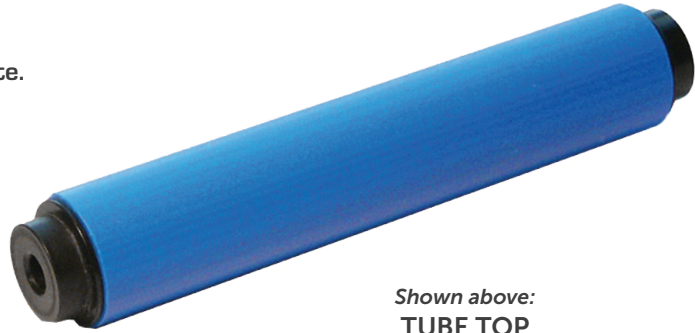

Shown above:
TUBE TOP
ROLLER

SPECIFICATIONS FOR TUBETOP ROLLERS

- Tube Top is perfect for applications where products need to accumulate on the conveyor.
- The tubes rotate freely on the stainless steel rods, acting as a roller allowing the chain to easily run under a stationary product without damaging it.
- TubeTop can incline or decline 2°.

NOTES:

The information that has been provided are guidelines only. This does not represent all design variations possible. For detailed or specific design requirements please contact a representative or email info@spantechllc.com.

TUBE TOP ROLLER & ACCUMULATION OPTIONS

KEY: LH = LEFT HAND • RH = RIGHT HAND • MSG = MOVING SIDE GUIDE • (PU) = POLYURETHANE • (S) = SANTOPRENE • (A) = ACETAL



DS5093
Ø16.0MM
TUBE TOP TUBE



DS0054-01A
Ø16.0MM
TUBE TOP BEARING
(A) CENTER LINK

OTHER ACCUMULATION OPTIONS:



DS0053P
Ø16.0MM
BARREL ROLLER
(PP) CENTER LINK



DA7000
SPHERICAL ROLLER

The information that has been provided are guidelines only. This does not represent all design variations possible. For detailed or specific design requirements please contact a representative or email info@spantechllc.com.

CHAIN TYPES

[LEGACY CHAIN]

The information that has been provided are guidelines only. This does not represent all design variations possible. For detailed or specific design requirements please contact a representative or email info@spantechllc.com.

ACETAL LINKS

KEY: LH = LEFT HAND • RH = RIGHT HAND • MSG = MOVING SIDE GUIDE • (PU) = POLYURETHANE • (S) = SANTOPRENE • (A) = ACETAL

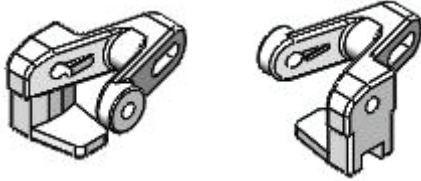

DS0120A - LEFT HAND PLAIN
DS0121A - RIGHT HAND PLAIN

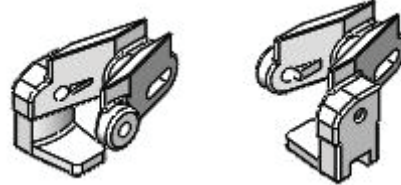

DS0124-01A - LEFT HAND 6MM RAISED
DS0125-01A - RIGHT HAND 6MM RAISED

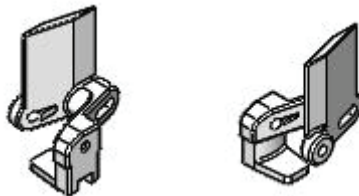

DS0123A - LEFT HAND 30MM MOVING SIDE GUIDE
DS0122A - RIGHT HAND 30MM MOVING SIDE GUIDE

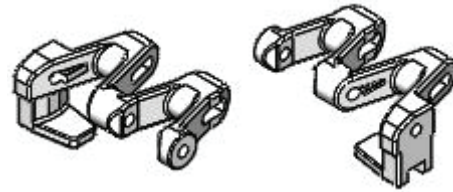

DS0146A - LEFT HAND COMBO PLAIN
DS0147A - RIGHT HAND COMBO PLAIN

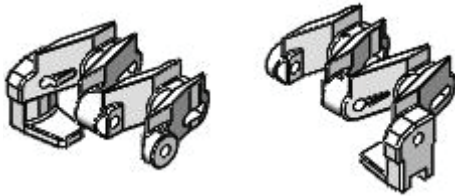

DS0148A - LEFT HAND COMBO 6MM RAISED
DS0149A - RIGHT HAND COMBO 6MM RAISED

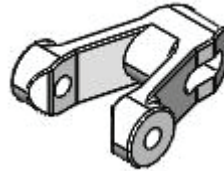

DS0001A -(A) PLAIN CENTER
DS0001P -(P) PLAIN CENTER

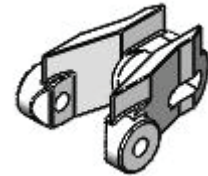

DS0002-01A
6MM RAISED TOP
(A) CENTER LINK

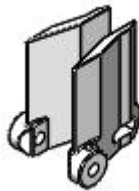

DS003-01-01A
30MM RAISED TOP CLEAT
(A) CENTER LINK

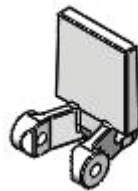

DS0005A
30MM PUSHER CLEAT
(A) CENTER LINK

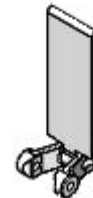

DS0005A-75
75MM PUSHER CLEAT
(A) CENTER LINK

The information that has been provided are guidelines only. This does not represent all design variations possible. For detailed or specific design requirements please contact a representative or email info@spantechllc.com.

SANTOPRENE & POLYURETHANE LINKS

KEY: LH = LEFT HAND • RH = RIGHT HAND • MSG = MOVING SIDE GUIDE • (PU) = POLYURETHANE • (S) = SANTOPRENE • (A) = ACETAL

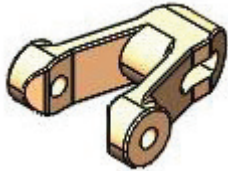

DS0001S55
55 DUROMETER
(S) CENTER LINK



DS0010-BT-PU
10MM BRUSH TOP
70 DUROMETER
(P) CENTER LINK

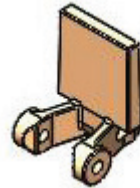

DS0005 (S55 - S87)
30MM PUSHER CLEAT
(S) CENTER LINK
55 OR 87 DUROMETER

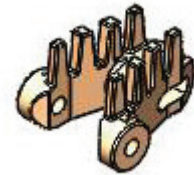

DS0010-BT-55
10MM BRUSH TOP
55 DUROMETER
(S) CENTER LINK

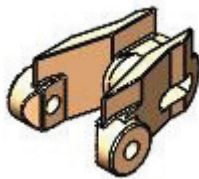

DS0002S-01S55
6MM RAISED TOP
(S) CENTER LINK

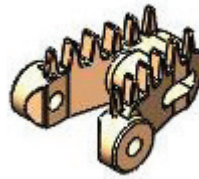

DS004-01-BT-55
6MM BRUSH TOP
55 DUROMETER
(S) CENTER LINK

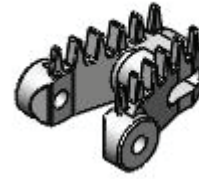

DS004-BT-PU
6MM BRUSH TOP
70 DUROMETER
(P) CENTER LINK

The information that has been provided are guidelines only. This does not represent all design variations possible. For detailed or specific design requirements please contact a representative or email info@spantechllc.com.

MONOSPAN CHAIN

Your best option for moving small parts.

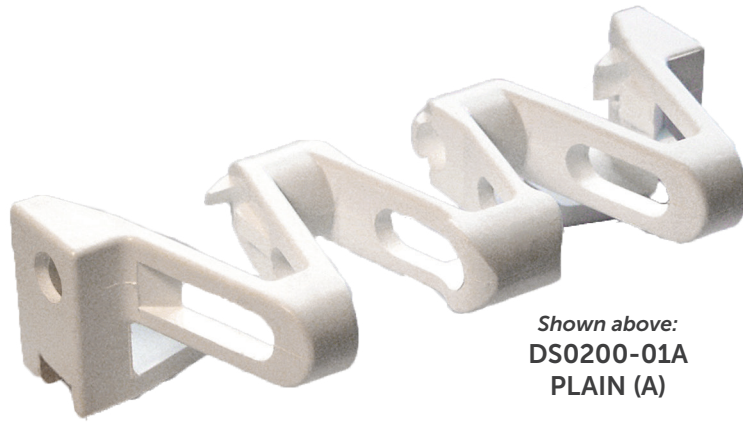

Shown above:
DS0200-01A
PLAIN (A)

Material Options

Available in acetal & santoprene.

Versatile

With a large amount of chain types available it can be used in many different applications.

Durable

MonoSpan chain is very lightweight yet very strong.

Sanitary

The open design concept improves cleanability.

SPECIFICATIONS FOR MONOSPAN CHAIN

- With a 51% open design, MonoSpan allows liquids & debris to fall through and can be washed down while still on the conveyor.
- MonoSpan also has an all plastic design making it ideal for use with metal detector sections.
- Load carrying capacity of 15 lbs/linear foot.
- Single link is 95.6mm (3.76") wide.
- Flexible design that can incorporate multiple curves and elevation changes.

CHAIN OPTIONS:

- Plain
- Raised Top

PITCH

- 25mm (0.98")

AVAILABLE WIDTH RANGE

- 95.6mm (3.76")
(95.6mm increments) (3.76" increments)

NOTES:

The information that has been provided are guidelines only. This does not represent all design variations possible. For detailed or specific design requirements please contact a representative or email info@spantechllc.com.

ACETAL & SANTOPRENE LINKS

KEY: LH = LEFT HAND • RH = RIGHT HAND • MSG = MOVING SIDE GUIDE • (PU) = POLYURETHANE • (S) = SANTOPRENE • (A) = ACETAL

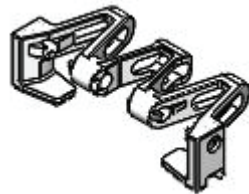

DS0200-01A - PLAIN (A)

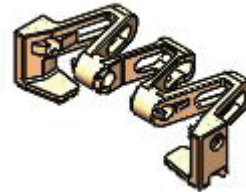

DS0200-01S55-1/2 - PLAIN 55D (S)

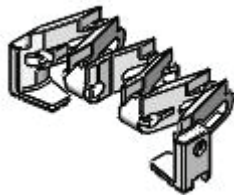

DS0200-03A - 6MM RAISED (A)



DS0200-03S55 - 6MM RAISED 55D (S)

The information that has been provided are guidelines only. This does not represent all design variations possible. For detailed or specific design requirements please contact a representative or email info@spantechllc.com.

MAXISPAN CHAIN

A top choice for its product cooling capabilities.

Material Options

Available in acetal & santoprene.

Versatile

With a large amount of chain types available it can be used in many different applications.

Sanitary

The open design concept improves cleanability.

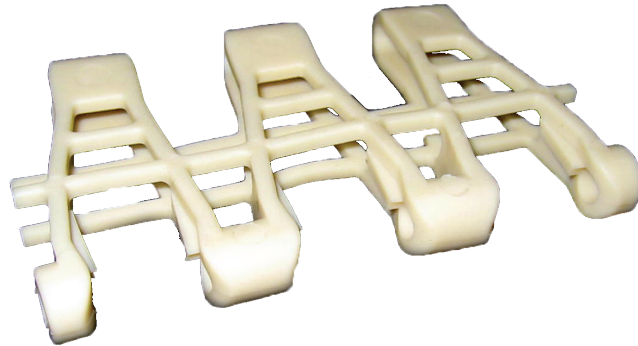

Shown above:
DS5201S55
PLAIN CENTER (S)

SPECIFICATIONS FOR MAXISPAN CHAIN

- With a 75% open design, MaxiSpan allows liquids & debris to fall through the chain meaning less downtime due to cleaning.
- MaxiSpan also has an all plastic design making it ideal for use with metal detector sections.
- Load carrying capacity of 25 lbs/ft².
- Recommended for product cooling.

CHAIN OPTIONS:

- Plain
- Raised Top
- Moving Side Guides
- Pusher Cleats
- Pusher w/Moving Side Guide

PITCH

- 50mm (1.97")

AVAILABLE WIDTH RANGE

- 209.2mm - 1209.2mm (100mm increments)
(8.24" - 47.61")
- *standard links will be machined for applicable widths

NOTES:

The information that has been provided are guidelines only. This does not represent all design variations possible. For detailed or specific design requirements please contact a representative or email info@spantechllc.com.

ACETAL & SANTOPRENE LINKS

KEY: LH = LEFT HAND • RH = RIGHT HAND • MSG = MOVING SIDE GUIDE • (PU) = POLYURETHANE • (S) = SANTOPRENE • (A) = ACETAL

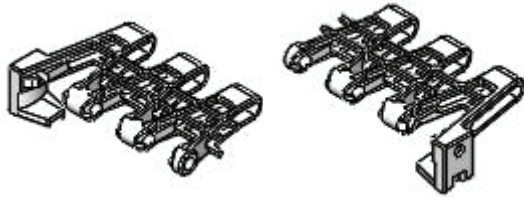

DS5210A - LH PLAIN (A)
DS5230A - RH PLAIN (A)



DS5218A - LH 30MM MSG (A)
DS5238A - RH 30MM MSG (A)



DS5212A - LH 6MM RAISED (A)
DS5232A - RH 6MM RAISED (A)



DS5220A - LH 6MM / 30MM MSG (A)
DS5240A - RH 6MM / 30MM MSG (A)

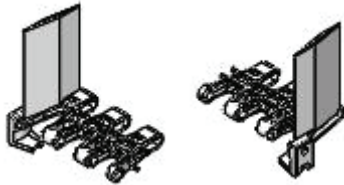

DS5214A - LH 75MM MSG (A)
DS5234A - RH 75MM MSG (A)

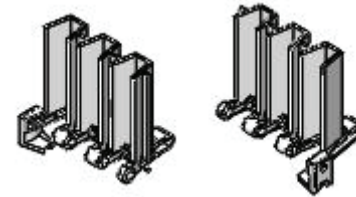

DS5222A - LH 75MM PUSHER CLEAT (A)
DS5242A - RH 75MM PUSHER CLEAT (A)

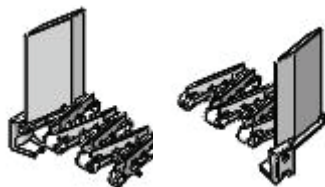

DS5216A - LH 6MM RAISED / 75MM MSG (A)
DS5236A - RH 6MM RAISED / 75MM MSG (A)



DS5224A - LH 75MM PUSHER CLEAT / MSG (A)
DS5244A - RH 75MM PUSHER CLEAT / MSG (A)

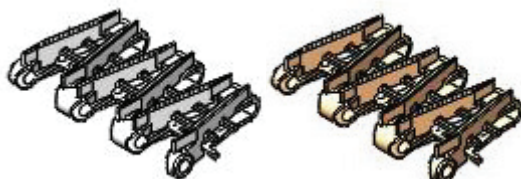

DS5203A - 6MM RAISED CENTER (A)
DS5203S55 - 6MM RAISED CENTER 55D (S)

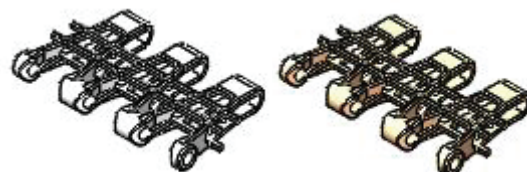

DS5201A - PLAIN CENTER (A)
DS5201S55 - PLAIN CENTER 55D (S)

The information that has been provided are guidelines only. This does not represent all design variations possible. For detailed or specific design requirements please contact a representative or email info@spantechllc.com.

CHAIN TYPES

[SPECIALTY CHAIN]

The information that has been provided are guidelines only. This does not represent all design variations possible. For detailed or specific design requirements please contact a representative or email info@spantechllc.com.

CLOSED TOP CHAIN

Sometimes you need a conveyor chain with a smooth, closed carrying surface.

Material Options

Acetal

Safety

Smooth, closed carrying surface with no open areas offering a measure of safety perfect for operator stations.



Shown above:
DS0069A
LH 50 MM MSG

SPECIFICATIONS FOR CLOSED TOP CHAIN

- Adding internal barrel rollers to the bottom of the chain will reduce chain pull.
- Adding internal barrel rollers will limit conveyor speeds to 70 ft/min or slower.
- Horizontal bends are not permitted with this chain design.
- Capable of vertical bends.
- Works well for pack-off applications.

CHAIN OPTIONS:

- Plain
- Moving Side Guide
- Pusher Cleat
- Scoop
- Pusher w/Moving Side Guide
- Scoop w/ Moving Side Guide

PITCH

- 25mm (0.98")

AVAILABLE WIDTH RANGE

- 95.6mm - 1205.6mm (3.76" - 46.28")

NOTES:

The information that has been provided are guidelines only. This does not represent all design variations possible. For detailed or specific design requirements please contact a representative or email info@spantechllc.com.

ACETAL LINKS

KEY: LH = LEFT HAND • RH = RIGHT HAND • MSG = MOVING SIDE GUIDE • (PU) = POLYURETHANE • (S) = SANTOPRENE • (A) = ACETAL

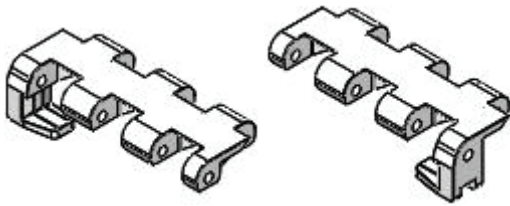

DS0063A - RH PLAIN (A)
DS0067A - LH PLAIN (A)

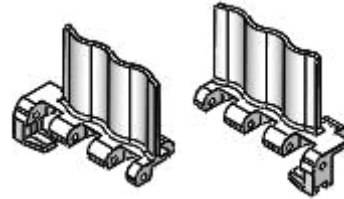

DS0068A - LH 50MM PUSHER (A)
DS0064A - RH 50 MM PUSHER (A)

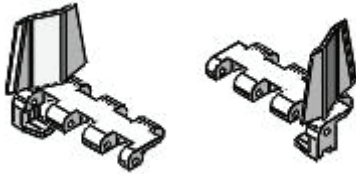

DS0069A - LH 50MM MSG (A)
DS0065A - RH 50MM MSG (A)

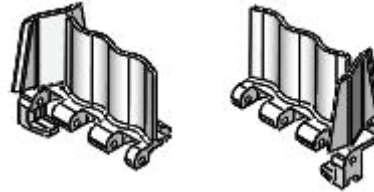

DS0070A - LH 50MM PUSHER/MSG (A)
DS0066A - RH 50MM PUSHER/MSG (A)

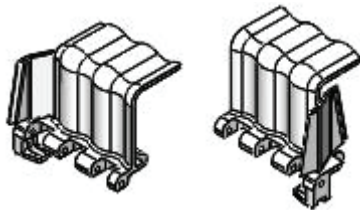

DS0057A - LH 50MM SCOOP/MSG (A)
DS0056A - RH 50MM SCOOP/MSG (A)

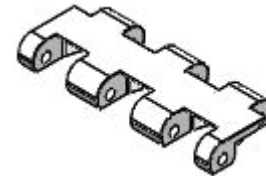

DS0061A - PLAIN CENTER (A)



DS0060A
INTERNAL BARREL ROLLER (A)



DS9964-CT-01
RETURN CHAIN
SUPPORT LINK (A)

The information that has been provided are guidelines only. This does not represent all design variations possible. For detailed or specific design requirements please contact a representative or email info@spantechllc.com.

MICROSPAN CHAIN

Modular chain designed to replace belt conveyor systems. End to end product movement has never been more adaptable than with MicroSpan Chain components & transfers.

Material Options

Acetal

Simple Repairs

MicroSpan chain has a snap fit design making section replacements as simple as possible.

Color Options

Microspan chain typically comes in blue but is also offered in grey.

Part Numbers

DA6600-2030	4MM PLAIN GREY
DA6600-2030-BLUE	4MM PLAIN BLUE
DA6600-2040	4MM RAISED GREY
DA6600-2040-BLUE	4MM RAISED BLUE
DA6600-2060-BLUE	6MM RAISED BLUE
DA6600-2060HF-BLUE	6MM HIGH FRICTION BLUE
DA6600-2050	6MM PLAIN GREY
DA6600-2050- BLUE	6MM PLAIN BLUE
DA6600-2060	6MM RAISED GREY

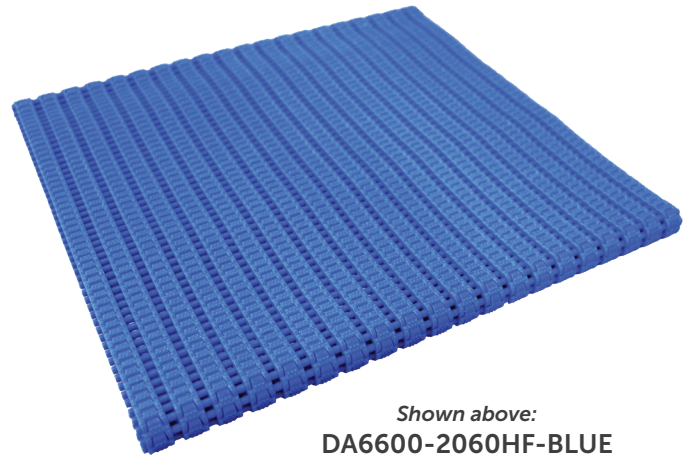

Shown above:
DA6600-2060HF-BLUE
6MM HIGH FRICTION
BLUE

SPECIFICATIONS FOR MICROSPAN CHAIN

- Typically used on transfers and EZSpan conveyors.
- Max load and torque is based off the chain width and speed.
- Capable of transferring around a 6mm nose bar.
- 6mm high friction chain option is available for inclining product.
- High friction option has a Santoprene insert.

CHAIN OPTIONS:

- 4mm & 6mm Plain
- Raised
- 6mm Raised High Friction

PITCH

- 5mm

AVAILABLE WIDTH RANGE

- 300mm (11.81") standard width. Can be cut to smaller widths or multiple chains for wider widths. (15mm increments)

NOTES:

The information that has been provided are guidelines only. This does not represent all design variations possible. For detailed or specific design requirements please contact a representative or email info@spantechllc.com.

ACETAL LINKS

KEY: LH = LEFT HAND • RH = RIGHT HAND • MSG = MOVING SIDE GUIDE • (PU) = POLYURETHANE • (S) = SANTOPRENE • (A) = ACETAL



DS801-30-06



DS801-60-06



DS8010-60BT-10MM



DS8010-30BT-10MM

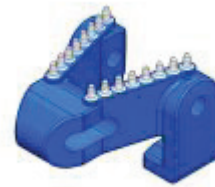

DS8010-30BT

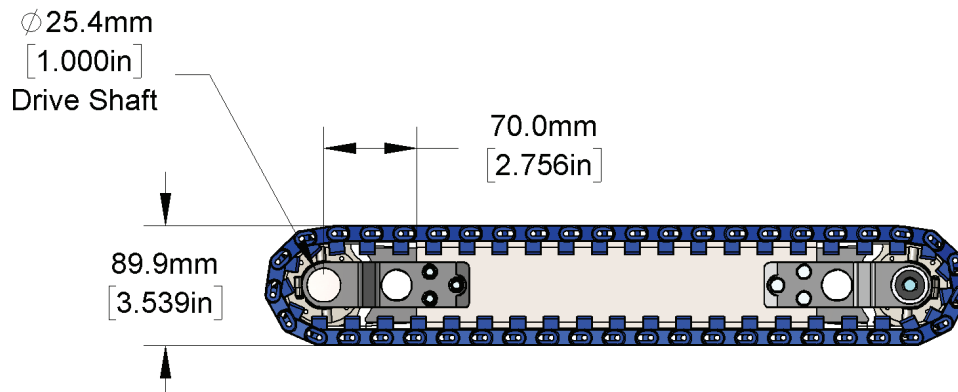
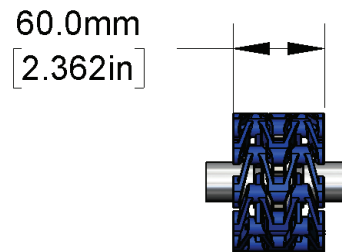
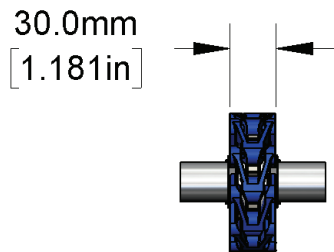

The information that has been provided are guidelines only. This does not represent all design variations possible. For detailed or specific design requirements please contact a representative or email info@spantechllc.com.

J-TRAX CHAIN

The smarter way to move food products.

Material Options

Acetal chain link & stainless steel rod

Simple Repairs

Very simple design with minimal parts allows for fast and easy repairs.

Durable

No wire-to-wire friction means no metal fatigue.

Sanitary

Fully washdown rated with stainless steel that is easy to clean and sanitize.

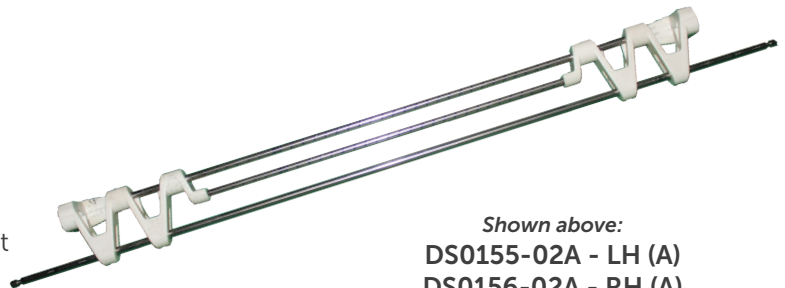

Shown above:
DS0155-02A - LH (A)
DS0156-02A - RH (A)

SPECIFICATIONS FOR J-TRAX CHAIN

- J-Trax has an open rod design making it ideal for the food industry.
- Applicable for: cooling, breading & battering, enrobing, depositing, draining/dewatering, drying and also general conveyance.
- Open rods facilitate rapid cooling of bakery items and let debris fall through rather than build up.
- 4mm diameter stainless steel rod with a 12mm pitch.

CHAIN OPTIONS:

- Plain

PITCH

- 25mm w/ 12mm intermittent rod

AVAILABLE WIDTH RANGE

- 95.6mm - 605.5mm (3.76" - 23.84")

NOTES:

The information that has been provided are guidelines only. This does not represent all design variations possible. For detailed or specific design requirements please contact a representative or email info@spantechllc.com.

ACETAL LINKS

KEY: LH = LEFT HAND • RH = RIGHT HAND • MSG = MOVING SIDE GUIDE • (PU) = POLYURETHANE • (S) = SANTOPRENE • (A) = ACETAL

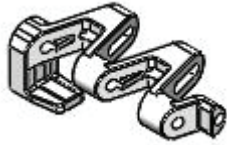

DS0155-02A - LEFT HAND (A)

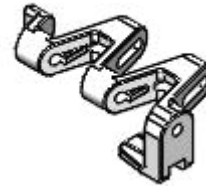

DS0156-02A - RIGHT HAND (A)

The information that has been provided are guidelines only. This does not represent all design variations possible. For detailed or specific design requirements please contact a representative or email info@spantechllc.com.

CONVEYORS

[DIRECTIONAL SECTIONS]

The information that has been provided are guidelines only. This does not represent all design variations possible. For detailed or specific design requirements please contact a representative or email info@spantechllc.com.

BED SECTIONS

Span Tech conveyors are manufactured with either steel or aluminum framing. Standard bed sections are 12 ft. in length with a crossbar every 24.0". Higher load applications use crossbars every 12.0" for more chain support. Individual bed sections are bolted together with an 8 hole pattern connecting strap.

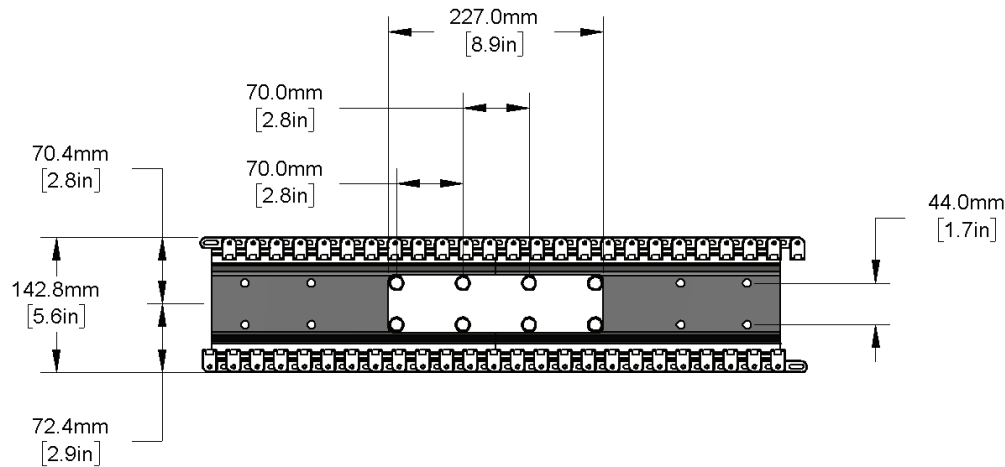

The illustration above is an elevation view of a conveyor bed section. Typical location dimensions are given for crossbar spacing as well as connecting strap hole locations. The overall bed section depth has also been noted, which applies to plain chain only. For raised top or cleated chain add 2 times the cleat height to the standard bed section depth.

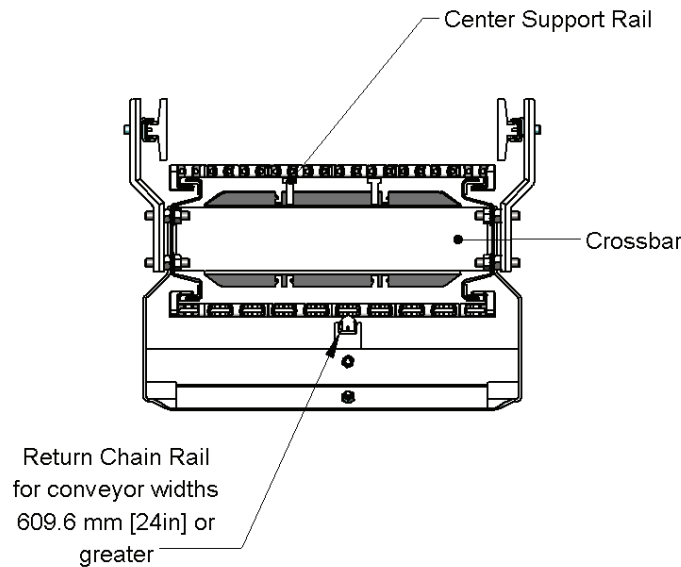

The illustration above represents a cross section view of a standard conveyor bed section with guide rails, center support rails, and return chain support rail.

The information that has been provided are guidelines only. This does not represent all design variations possible. For detailed or specific design requirements please contact a representative or email info@spantechllc.com.

HORIZONTAL CURVES

One of the most unique features of Span Tech's family of conveyors is the horizontal curve. Horizontal curves can be manufactured to any degree angle at any radius staying within the rules. When designing conveyors that incorporate horizontal curves, be certain to apply the following rules of thumb.

👍 Between offsetting Horizontal Curves (S-curves) there should be a straight section that is greater than or equal to 2 times the chain width. This applies to all conveyors within the Span Tech family.

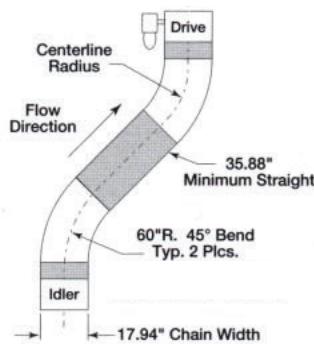

The illustration above shows the placement of straight sections between offsetting curves for a MultiSpan conveyor.

The following rule applies to all 25mm chain.

👍 From the end of a Horizontal Curve to the end of a drive or idler, there should be a straight section with a length that is greater than or equal to the chain width.

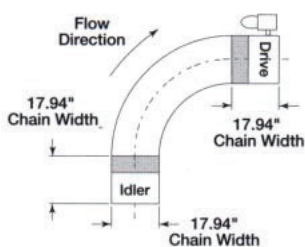

MultiSpan Curve Rule

Use the following formulas to calculate the minimum centerline radius for all Span Tech conveyors.

MultiSpan chain's minimum centerline turning radius is equal to:

$$\text{Chain Width}^{\text{inches}} \times 3.12$$

$$\text{Chain Width}^{\text{mm}} \times 3.12$$

MaxiSpan chain's minimum centerline turning radius is equal to:

$$\text{Chain Width}^{\text{inches}} \times 3.48 - 6.91"$$

$$\text{Chain Width}^{\text{mm}} \times 3.48 - 175.5\text{mm}$$

25MM SuperTight chain's minimum centerline turning radius is equal to:

$$\text{Chain Width}^{\text{inches}} \times 2.29 - 2.64"$$

$$\text{Chain Width}^{\text{mm}} \times 2.29 - 67.06\text{mm}$$

50MM SuperTight chain's minimum centerline turning radius is equal to:

$$\text{Chain Width}^{\text{inches}} \times 1.93$$

$$\text{Chain Width}^{\text{mm}} \times 1.93$$

The absolute minimum centerline turning radius for any of Span Tech conveyors is 18.0" (457.20mm) for aluminum framing and 21.0" (533.40mm) for steel framing.

The following rule applies to all 50mm chain.

👍 From the end of a Horizontal Curve to the end of a drive or idler, there should be a straight section with a length that is greater than or equal to 2 times the chain width.

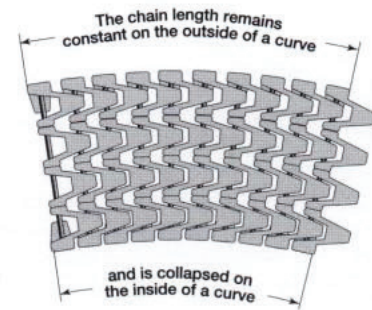
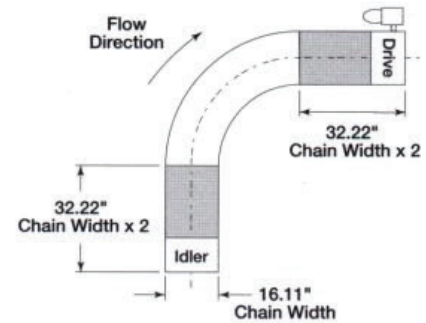

Chain condition while traveling through a horizontal curve

The reason for following the previous rules when applying horizontal curves in a conveyor layout is illustrated above. The pitch length of the chain is constant on the outside radius of a curve and is collapsed on the inside radius of a curve. The chain must have time for the rods to straighten out allowing the chain stress to be redistributed evenly before making another direction change along the conveyor path.

The information that has been provided are guidelines only. This does not represent all design variations possible. For detailed or specific design requirements please contact a representative or email info@spantechllc.com.

VERTICAL BENDS

Elevation changes in a conveyor layout can be accomplished in various ways but the most common method is with the use of vertical bends.

The Span Tech family of conveyors uses molded plastic vertical bends made of high density polypropylene.

Vertical bends have a centerline radius of 15.75" (400mm) and range from 4° to 90° angles in increments of 1°.

Use the following rules of thumb when designing conveyor layouts that include vertical bends for making elevation changes.

👍 Drive or Idler assemblies can be attached directly to a vertical bend assembly.

Incline Angle	Rise/ Ft. Inches	Rise/Ft MM	Incline Angle	Rise/ Ft. Inches	Rise/Ft MM	Incline Angle	Rise/ Ft. Inches	Rise/Ft MM
1°	0.209	5.32	21°	4.606	117.00	41°	10.431	264.96
2°	0.419	10.64	22°	4.848	123.15	42°	10.805	274.44
3°	0.629	15.97	23°	5.094	129.38	43°	11.190	284.23
4°	0.839	21.31	24°	5.343	135.71	44°	11.588	294.34
5°	1.050	26.67	25°	5.596	142.13	45°	12.000	304.80
6°	1.261	32.04	26°	5.853	148.66	46°	12.426	315.63
7°	1.473	37.42	27°	6.114	155.30	47°	12.868	326.86
8°	1.686	42.84	28°	6.381	162.07	48°	13.327	338.51
9°	1.901	48.28	29°	6.652	168.95	49°	13.804	350.63
10°	2.116	53.74	30°	6.928	175.98	50°	14.301	363.25
11°	2.333	59.25	31°	7.210	183.14	51°	14.819	376.40
12°	2.551	64.79	32°	7.498	190.46	52°	15.359	390.13
13°	2.770	70.37	33°	7.793	197.94	53°	15.925	404.48
14°	2.992	76.00	34°	8.094	205.59	54°	16.517	419.52
15°	3.215	81.67	35°	8.402	213.42	55°	17.138	435.30
16°	3.441	87.40	36°	8.719	221.45	56°	17.791	451.88
17°	3.669	93.19	37°	9.043	229.68	57°	18.478	469.35
18°	3.899	99.04	38°	9.375	238.14	58°	19.204	487.78
19°	4.132	104.95	39°	9.717	246.82	59°	19.971	507.27

Shown above is the rise per foot for elevation changes at various angles.

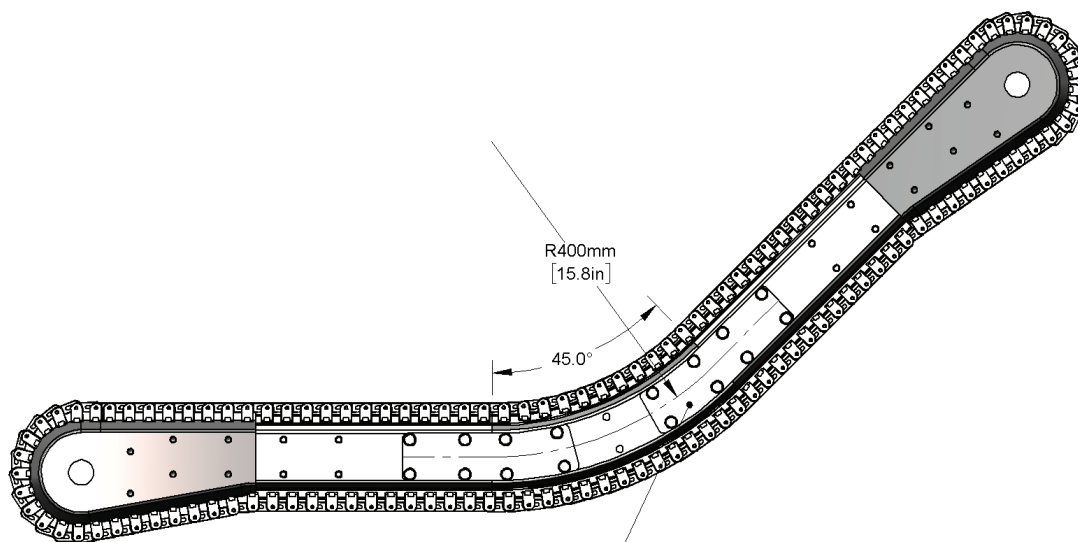

2° - 30° vertical bends have one (1) connecting strap per side
 > 30° vertical bends have two (2) connecting straps per side

The information that has been provided are guidelines only. This does not represent all design variations possible. For detailed or specific design requirements please contact a representative or email info@spantechllc.com.

SUPPORT STRUCTURES

Standard Supports [1]

Span Tech standard stainless steel or painted mild steel supports are 2" x 2" tubing, with a 1" x 1" horizontal cross brace.

👍 **Standard support elevations are 12" - 84" Top of Conveyor.**

Drive Supports [2]

Drive supports include an additional extended bottom brace to help stabilize the drive end of the conveyor.

Aluminum Supports [3]

Aluminum Supports are "C" channel.

Support Feet Options [4]

Each support comes with optional feet types.

- Bolted to the floor. [4a]
- Free standing on padded feet. [4b]
- Lockable swivel casters. [4c]

Ceiling Support Options [5]

Ceiling support brackets are used for all elevations over 84" Top of Conveyor unless specified by the customer (at which the job becomes a special design).

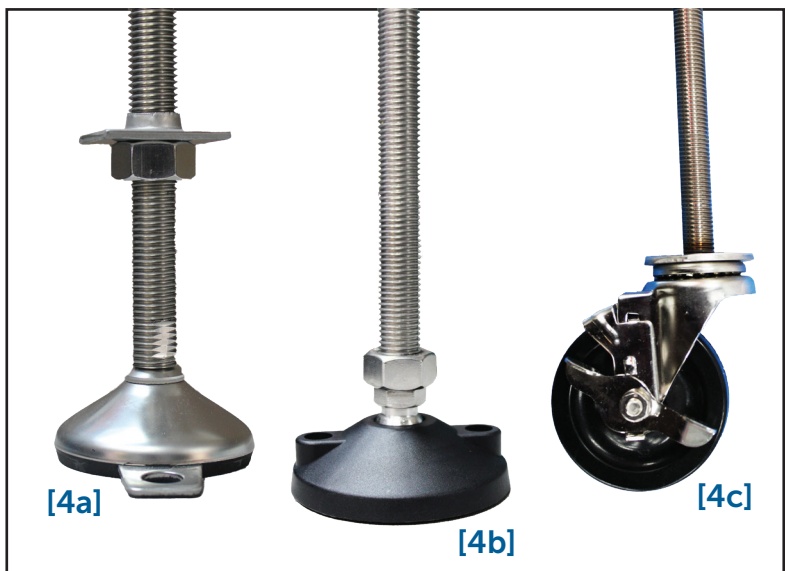
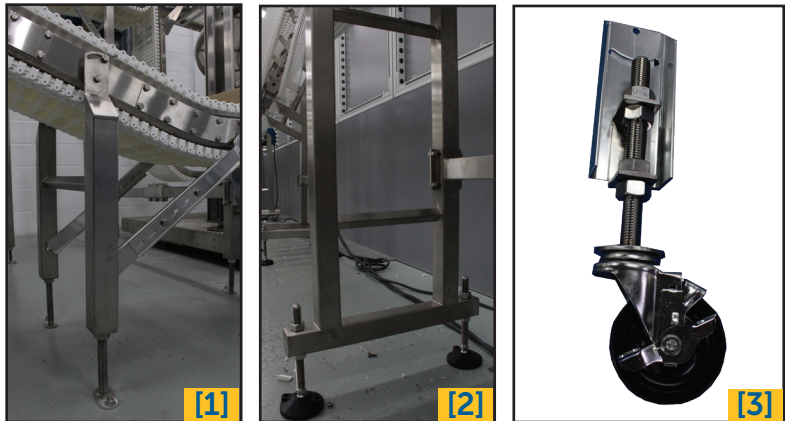

The information that has been provided are guidelines only. This does not represent all design variations possible. For detailed or specific design requirements please contact a representative or email info@spantechllc.com.

CONVEYORS

[ELEVATION CHANGE]

The information that has been provided are guidelines only. This does not represent all design variations possible. For detailed or specific design requirements please contact a representative or email info@spantechllc.com.

TOPPER LIFT

Tackle tricky angles, product orientation and elevation change with a smaller footprint. The Topper Lift puts steep angles within your reach.

Product Handling

The Topper Lift is capable of handling rigid or flexible products such as bagged, boxed, or frozen items.

Impressive Elevation

Most cost effective for elevating up to 60°

No PLC? No Problem

No programmable logic controller (PLC) is needed to run the Topper Lift.

Configurable Width

Using our standard chain widths, the Topper Lift's width can be configured to fit your needs and footprint.



RULES OF THUMB FOR TOPPER LIFTS

MAX RECOMMENDED ANGLE: 60°

MAX RECOMMENDED SPEED: 200 fpm

PRODUCT PITCH = 4 * PRODUCT LENGTH

- The Topper Lift conveyor system sandwiches a product between two conveyor chains, in order to apply pressure across the top of the product and prevent it from tipping over. This allows the product to be transported at excessive angles that would not be possible on a standard incline conveyor.
- There must be (3) product lengths between adjacent products.
- Chain width must be at least 4.75" wider than the product in order to guarantee full high friction module coverage.
- There must be at least 12" of vertical clearance above the top of the product.
- Multiple lanes of product are not recommended.

- The top conveyor must be driven with a VFD in order to set the right speed for the application (in some instances it could run slightly faster or slower than the bottom conveyor).

NOTES:

The information that has been provided are guidelines only. This does not represent all design variations possible. For detailed or specific design requirements please contact a representative or email info@spantechllc.com.

OUTRUNNER SPIRAL

A cost effective solution for changing elevations. Gives you the capacity to move a wide range of product types without taking up valuable floor space.

Small Footprint

Save floor space by elevating with an Outrunner Spiral.

Extremely Configurable

A variable height, diameter, angle, chain width, infeed, and exit location.

Applications Include

Elevating, cooling, curing, and dwell times.

Catenary Free

Our chain is captured throughout the entire system making the Outrunner Spiral safer than other spirals.



RULES OF THUMB FOR OUTRUNNER SPIRALS

MAX INCLINE ANGLE: 25°

MAX DECLINE ANGLE: 4°

MINIMUM TIER PITCH: 4.92" (125mm)

MAX SPEED LIMITS BASED ON CHAIN WIDTH:

3.76" - 7.31" = 250 fpm (95.5mm - 185.7mm)

8.49" - 12.03" = 200 fpm (215.6mm - 305.6mm)

13.21" - 17.94" = 175 fpm (335.5mm - 455.7mm)

19.11" - 23.84" = 150 fpm (485.4mm - 605.5mm)

- All Outrunner Spirals must have a controlled stop/start sequence (smooth acceleration/deceleration) to prevent chain from crowding into the Outrunner Drive sprocket.

- All Outrunner Spirals must be designed with Pillow Top or SuperTight 6mm or 30mm moving side guides on the sides where it is driven by the Outrunner sprockets. In addition, the opposite side of the chain should also be supplied with a moving side guide unless a side by side transfer is required.

- Outrunner Spirals are intended to add dwell time to a product flow, but are not intended to be accumulation devices (holding product while the spiral runs).

- Outrunner Spirals will NOT maintain product orientation.

- A torque limiter between the gearmotor and the primary sprocket is required and this torque limiter must have an accompanying proximity sensor to tell the PLC or VFD to stop the spiral in case of an over-torque condition.

NOTES:

The information that has been provided are guidelines only. This does not represent all design variations possible. For detailed or specific design requirements please contact a representative or email info@spantechllc.com.

HELICAL CURVE

Our Helical Curve makes simultaneous direction and elevation change a breeze.

Industry Leader

The Helical Curve has the most aggressive elevation change to curve radius in the industry.

Top-Notch Turning Radius

Offers the tightest turning radius in the industry that others can not provide.

Incline / Decline

Versatility with inclining and declining.

Catenary Free

Chain is captured throughout the entire system which makes the Helical Curve safer than the competition.



RULES OF THUMB FOR HELICAL CURVES

- MAXIMUM ANGLE: 25°
- Above 5° requires a larger centerline radius.
- Above 10° add the following extra length to the already existing 12" bed section adjacent to the Helical Curve.
 - 5.5" for opposing curves
 - 2.75" for a single curve

NOTES:

The information that has been provided are guidelines only. This does not represent all design variations possible. For detailed or specific design requirements please contact a representative or email info@spantechllc.com.

WEDGE UNIT

The Wedge Unit provides vertical movement in a compact and all mechanical design for ultimate reliability.

Small Footprint

The Wedge Unit has an extremely small footprint compared to elevation change.

Impressive Elevation

Elevation of up to 30 feet.

Technology Not Required

No expensive controls are needed to operate the Wedge Unit.

Handles Most Rigid Products

Available in a wide variety of chain types and widths to accommodate a large array of products.

Version Options

You have the choice of a positionable or fully adjustable unit (which can be motor driven).



RULES OF THUMB FOR WEDGE UNITS

MAX SPEED:

180 feet per minute. (55 mpm)

MINIMUM INFEED ELEVATION: 26 inches

OVERALL WIDTH:

39.1" - positionable units

48.4" - 0 - 12" adjustable units

60.4" - 0 - 24" adjustable units

- Wedge conveyors must be equipped with a variable frequency drive (VFD) with soft start/stop capability. The VFD can be customer supplied or provided by Span Tech.

- If your incoming product does not meet the minimum gap requirements, you may increase the velocity of the Wedge Unit to pull the needed gap. Use the basic formula below to find the necessary velocity of the Wedge Unit.

$$V_w = V_o (L + Gap_{min} / L + Gap_i)$$

V_w = Desired velocity of Wedge unit (FPM)

V_o = Initial velocity of incoming conveyor (FPM)

Gap_{min} = minimum gap required

Gap_i = initial product gap

STANDARD CHAIN WIDTHS / CENTER LINE RADIUS :

6.13 inches - 21"

7.31 inches - 22.81"

8.49 inches - 26.49"

9.67 inches - 30.45"

10.85 inches - 33.85"

RECOMMENDED PRODUCT HEIGHT RESTRICTIONS:

6.13" - 2.0" - 6.9"

7.31" - 7.0" - 11.9"

8.49" - 12.0" - 16.9"

9.67" - 17.0" - 21.9"

10.85" - 22.0" - 24.0"

- The spacing between products (gap) is critical to the layout of the Wedge Unit. If the gap is too small, products could contact and interfere with each other through the curves. Use the following formula to determine the minimum gap for your product.

$$Gap_{min} = (L+1) / (2R/H) - 1$$

R =Radius of Curve (referenced above),

H =Height of product,

L =Length of product,

Gap_{min} =Minimum gap required for your product

The information that has been provided are guidelines only. This does not represent all design variations possible. For detailed or specific design requirements please contact a representative or email info@spantechllc.com.

WEDGE UNIT [CONTINUED]

DYNAMIC LOAD CAPACITY:

• 10' OFFSET

Chain Width	50 FPM	100 FPM	150 FPM	180 FPM
6.13"	92lbs	40lbs	22lbs	27lbs
7.31"	92lbs	38lbs	20lbs	24lbs
8.49"	92lbs	37lbs	19lbs	21lbs
9.67"	92lbs	36lbs	17lbs	18lbs
10.85"	91lbs	34lbs	15lbs	15lbs

• 20' OFFSET

Chain Width	50 FPM	100 FPM	150 FPM	180 FPM
6.13"	146lbs	62lbs	35lbs	25lbs
7.31"	145lbs	60lbs	32lbs	22lbs
8.49"	143lbs	58lbs	29lbs	19lbs
9.67"	142lbs	55lbs	26lbs	17lbs
10.85"	140lbs	52lbs	23lbs	15lbs

• 30' OFFSET

Chain Width	50 FPM	100 FPM	150 FPM	180 FPM
6.13"	181lbs	85lbs	47lbs	34lbs
7.31"	176lbs	82lbs	43lbs	31lbs
8.49"	170lbs	78lbs	39lbs	26lbs
9.67"	164lbs	74lbs	35lbs	22lbs
10.85"	159lbs	71lbs	31lbs	18lbs

NOTES:

The information that has been provided are guidelines only. This does not represent all design variations possible. For detailed or specific design requirements please contact a representative or email info@spantechllc.com.

CONVEYORS

[SORTING & MERGING]

The information that has been provided are guidelines only. This does not represent all design variations possible. For detailed or specific design requirements please contact a representative or email info@spantechllc.com.

POWERED DIVERT

Alleviate accumulation issues with a Powered Divert, an ideal solution for non-rigid and rigid products.

Adjustable

Manually or pneumatically adjusted.

Motor Options

Powered by a WA20 or WA30 gearmotor.

Power Forward

Helps product continue moving forward which alleviates accumulation issues.

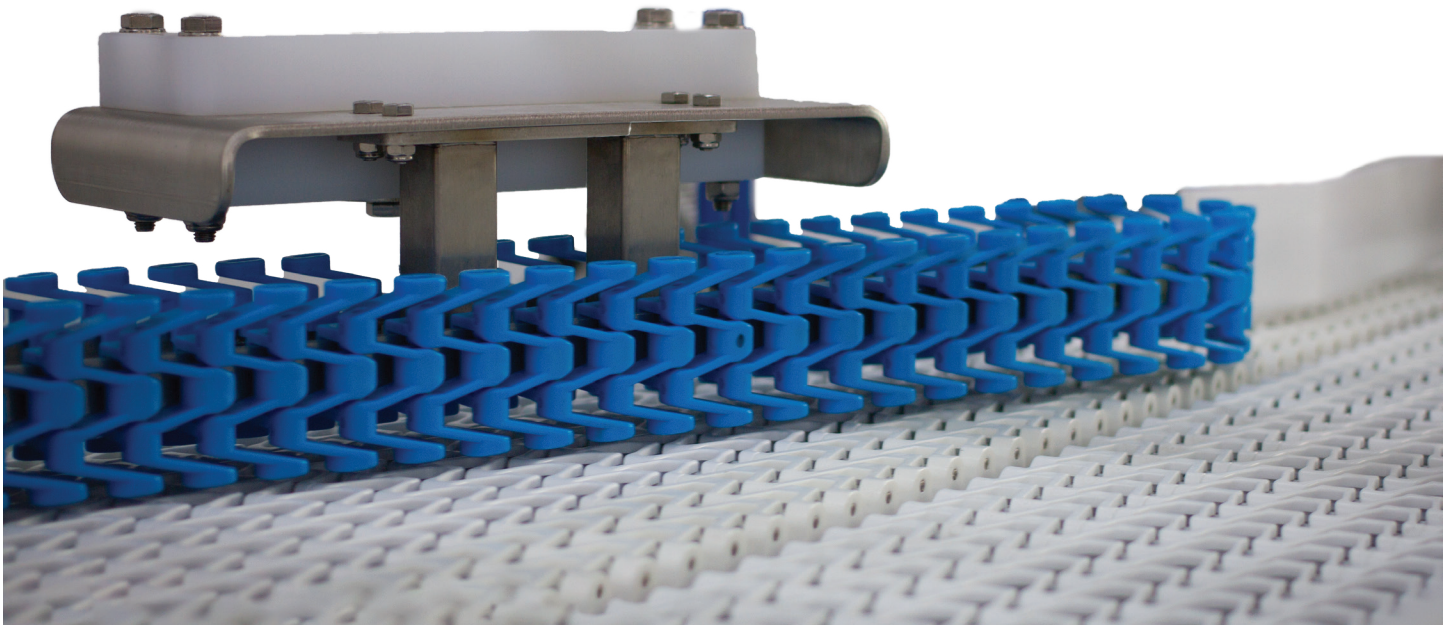

RULES OF THUMB FOR POWERED DIVERTS

- Products can be rigid or flexible to use the Powered Divert.
- Products must be large enough so as not to fall between the two parallel conveyors.
- Comes in two options: manual adjusting MiniLink or pneumatic adjusting.
- Uses 60mm MiniLink only.
- Helps maintain orientation & eliminates friction/rubbing associated with static divert rails.

NOTES:

The information that has been provided are guidelines only. This does not represent all design variations possible. For detailed or specific design requirements please contact a representative or email info@spantechllc.com.

TRANSPOSITOR

Successfully creates right-angle product transfers without skewing.

Product Handling

Has the ability to handle almost any type of product.

Low Maintenance

No lubrication is required to run, making it virtually maintenance free.

Efficiency

Safe, low-noise running off of 24 volts.

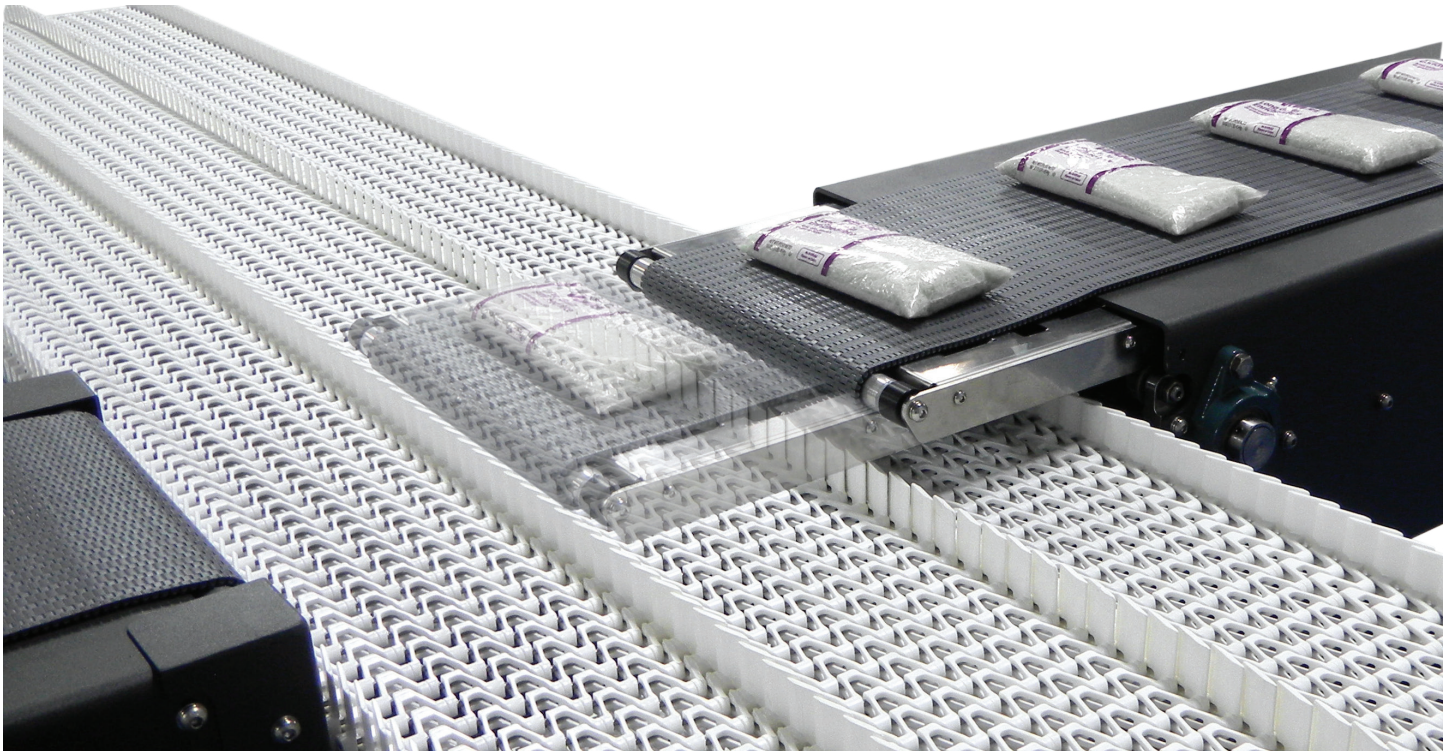

RULES OF THUMB FOR TRANSPOSITORS

- Transpositors can be used as a product reject or divert for delicate products.
- Ideal for feeding wrappers, casepackers, and handpack stations.
- Sprocket driven chain.
- Build product lanes or patterns across the width of receiving conveyors.
- Can be 300mm or 600mm wide.
- Retract speed of 300 fpm.
- Forward speed of 150 fpm.
- Available cross belts for side to side diverts.

NOTES:

The information that has been provided are guidelines only. This does not represent all design variations possible. For detailed or specific design requirements please contact a representative or email info@spantechllc.com.

VERTICAL SWITCH



The Vertical Switch can be designed to divide flow between two elevations or if needed as a product reject.

Elevation Options

Allows product to be discharged at multiple elevations. Can be used as a reject system.

Cleanability

Built for washdown applications.

Versatile

Can be designed with MicroSpan technology or standard conveyor design.

RULES OF THUMB FOR VERTICAL SWITCHES

- Can be used to design flow or merge flow.
- Typically slave driven off of discharge conveyor. Can be independently driven.
- Can be designed with custom lengths.
- Can be used in decline or incline applications.
- Can be used as a reject system.

NOTES:

The information that has been provided are guidelines only. This does not represent all design variations possible. For detailed or specific design requirements please contact a representative or email info@spantechllc.com.

PUSHERS & SQUEEZE STOPS

Pusher Stations sort your products efficiently by ejecting them or halting them altogether.

Heavy Duty

Construction is suitable for very heavy products.

Design Options

Available in two different applications: pneumatic cylinder or electric motor.

Application Options

Options include: product sorting, palletizing, or rejecting.

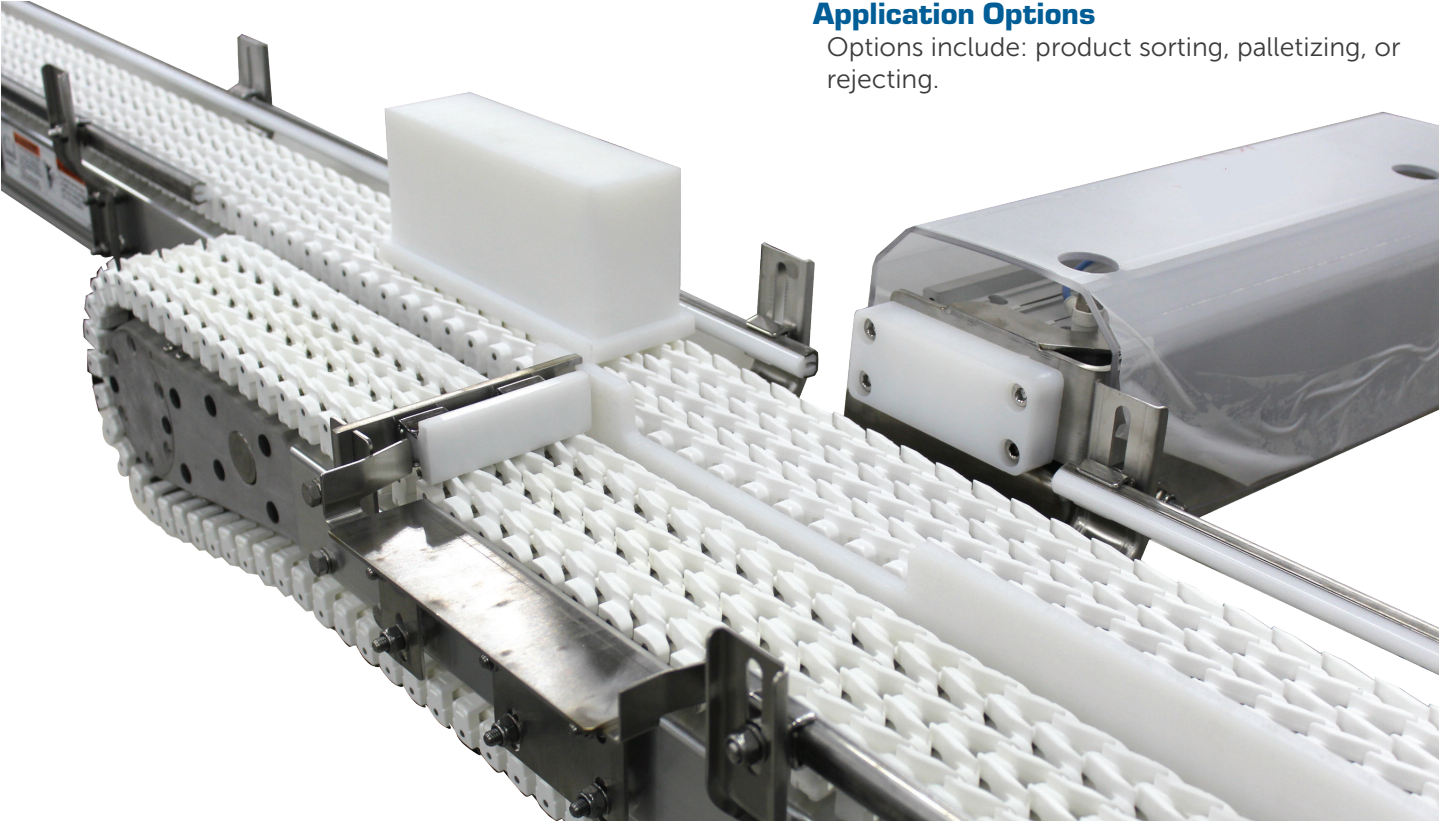

RULES OF THUMB FOR PUSHERS & SQUEEZE STOPS

PNEUMATIC MAX RATE:
20 parts per minute

MATRIX PUSHER MAX RATE:
40 parts per minute

* Rates above are maximums - rates are dependent on the stroke of the pusher. It takes longer to push something across a wider conveyor than a narrow one.

- Conveyor cannot have a moving side guide unless the entire chain is raised, and even then the conveyor is limited to 6mm raised.

- A minimum gap is required for a Pusher Station and is necessary to give the pusher mechanism time to retract, so it does not collide with the next product.

- Additional bed section crossbars are used at pusher location.

NOTES:

The information that has been provided are guidelines only. This does not represent all design variations possible. For detailed or specific design requirements please contact a representative or email info@spantechllc.com.

HIGH SPEED SWITCH

The High Speed Switch divides your product flow effectively, quickly and reliably.



Fast

Switch up to 300 parts per minute.

Reliable

Virtually crash proof with the patented toggle system design.

Very Configurable

Lots of configuration options: 1:2, 1:3, 1:4, 2:4.

Low Maintenance

The High Speed Switch is rated for continuous 24 hour per day operation.

RULES OF THUMB FOR HIGH SPEED SWITCHES

- MAX SPEED: **350 feet per minute.**
- MAXIMUM CARRIER ROD LENGTH: **48 inches**
- MINIMUM PRODUCT LENGTH (DIAMETER): **4 inches**
- MINIMUM CARRIER OFFSET: **1:3 or greater = 4.75 inches**

- There must be 4 inches of gap between successive products.
- Can be built with lexan guarding for even greater safety.
- Uses coated steel rods or anodized aluminum rods.
- High Speed Switches will not run in reverse direction.

NOTES:

The information that has been provided are guidelines only. This does not represent all design variations possible. For detailed or specific design requirements please contact a representative or email info@spantechllc.com.

CONVEYORS

[SPECIALTY]

The information that has been provided are guidelines only. This does not represent all design variations possible. For detailed or specific design requirements please contact a representative or email info@spantechllc.com.

EZSPAN CONVEYOR

EZSpan uses extremely thin, modular plastic chain giving you several advantages over typical belt conveyors.

No Tracking Issues

Uses sprocket driven modular plastic chain (not fabric belt) eliminating any tracking issues.

Constant End to End Distance

No take-up units at the ends of the conveyor, meaning the length you order is the length you get.

No Integration Problems

The thinnest standard belt conveyor made, making it very easy to integrate with other machinery.

Hassle Free Maintenance

The drive unit has been designed for increased performance and to make maintenance easy.



RULES OF THUMB FOR EZSPAN CONVEYORS

- 300mm MicroSpan plain or raised chain.
- 2.4' - 30' lengths available.
- VFD INCLUDED W/ AVAILABLE OPTIONS
120/240 VAC (1p) or 240 VAC (3p).
- SPEED RANGE - 30 - 110 fpm.
- Optional supports beginning at conveyor lengths of
3.2' or longer.
- 29" - 45" support elevations.
- 34" - 50" caster support elevation.
- Optional adjustable guide rails.
- Optional low profile nose bar ends.
(18mm OD of chain)
- Non-washdown.

NOTES:

The information that has been provided are guidelines only. This does not represent all design variations possible. For detailed or specific design requirements please contact a representative or email info@spantechllc.com.

ENDLESS LOOP

The Endless Loop conveyor is a great option when the need to completely eliminate transfers is required.

Functionality

Endless Loops are very functional in assembly line applications, and in applications with small product completely eliminating the need for transfers.



RULES OF THUMB FOR ENDLESS LOOPS

- Endless Loop conveyors can use 1 or 2 Outrunner Drives using a single VFD.
- If more than 2 Outrunner Drives are necessary, special controls are necessary.
- Any length of loop is possible.
- Outrunner Drives must be located on the curves.
- Endless Loops are especially good for inspection / assembly systems.
- Endless loops are relatively less expensive than standard conveyors because they use half the chain.

NOTES:

The information that has been provided are guidelines only. This does not represent all design variations possible. For detailed or specific design requirements please contact a representative or email info@spantechllc.com.

CONVEYORS

[ACCUMULATION]

The information that has been provided are guidelines only. This does not represent all design variations possible. For detailed or specific design requirements please contact a representative or email info@spantechllc.com.

ACCUMULATION RULES

Accumulation on Tube Top Chain:

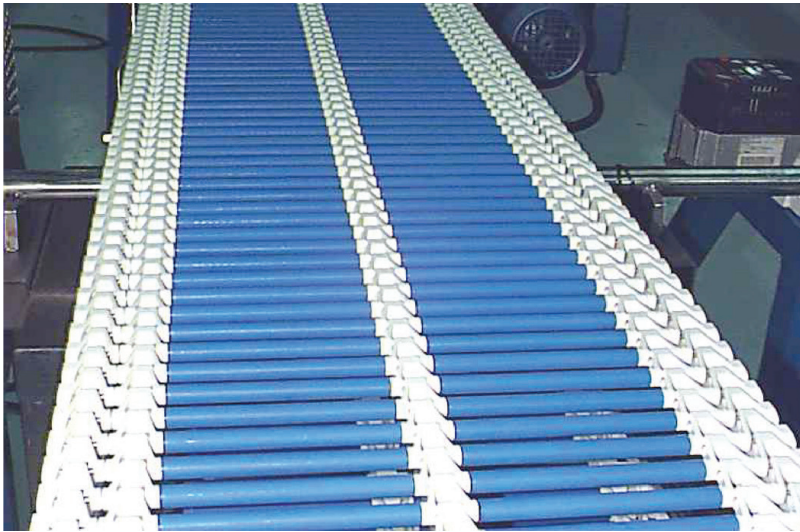

- Back pressure decreases drastically when accumulating on Tube Top Chain.
- Increasing the angle of the Tube Top accumulation conveyor can drop the back pressure further.
- Because the tubes roll underneath the product during accumulation, the product surface is not damaged during accumulation.

Tube Top Chain was created so that more products could be accumulated than what was possible on plain chains. The tubes rotate freely under products that are stopped on the chain allowing a longer slug of products to accumulate without crushing the first product.

Accumulation on Curved Conveyors:



Accumulated Round Products:

Pull a gap as the product exits the 180° bend due to the compression and expansion of the conveyor chain underneath the product. Accumulated round products maintain orientation because they keep a single point of contact through the curve.

Accumulated Square Products:

Pull a gap as the product exits the 180° bend due to the compression and expansion of the conveyor chain underneath the product. Accumulated square products also skew as they exit the curve due to the point of contact shifting from the product side to the corner as it moves through the curve. Square products can also lock up and get wedged between the guiderail.

The information that has been provided are guidelines only. This does not represent all design variations possible. For detailed or specific design requirements please contact a representative or email info@spantechllc.com.

CONVEYORS

[DRIVES & GEAR MOTORS]

The information that has been provided are guidelines only. This does not represent all design variations possible. For detailed or specific design requirements please contact a representative or email info@spantechllc.com.

DRIVES

Flexibility matched with power and durability is the essence of Span Tech drives.

The conveyor chain flexes around the end of the conveyor, over the drive sprockets and continues underneath without ever leaving the frame. There is no loose catenary to contend with. The chain will be captured at all times.

Drive sprockets are two piece units making maintenance and repair quick and simple. The drive shaft does not have to be removed for sprocket replacement. Sprockets are also protected by a shear pin making an expensive friction clutch unnecessary.

The drive sprockets are mounted on a 1 1/4" diameter stainless steel drive shaft. One end of this drive shaft can extend out whichever side of the conveyor is preferred.

Drives and idlers are identical in design. The conveyor drive can be positioned at either end of the conveyor, or either side resulting in either a push or pull drive or somewhere in the center using an intermediate drive.

Various drive arrangements are possible with Span Tech family of conveyors such as the hollow shaft mount, remote mount (chain and sprockets) and the coupled mount. A selection of motor and gearbox combinations are available to power Span Tech conveyors in the most demanding applications.

The MaxiSpan and 50mm SuperTight sprocket assembly has 11 teeth and a pitch radius of 3.49" (88.7mm). Chain travel per sprocket revolution is equal to 1.83 ft. (0.55 meters).

The Multispan, Monospan and 25mm SuperTight sprocket assembly has 21 teeth and a pitch radius of 3.29" (83.5mm). Chain travel per sprocket revolution is equal to 1.72 ft. (0.52 meters).

MaxiSpan and 50mm SuperTight chain speed can be calculated using the following formulas.

$$\text{Chain speed}^{(\text{ft}/\text{min})} = \text{shaft rpm} \times 1.83 \text{ ft.}$$

$$\text{Chain speed}^{(\text{meters}/\text{min})} = \text{shaft rpm} \times 0.55 \text{ meters.}$$

MultiSpan, MonoSpan and 25mm SuperTight chain speed can be calculated using the following formulas.

$$\text{Chain speed}^{(\text{ft}/\text{min})} = \text{shaft rpm} \times 1.72 \text{ ft.}$$

$$\text{Chain speed}^{(\text{meters}/\text{min})} = \text{shaft rpm} \times 0.52 \text{ meters.}$$

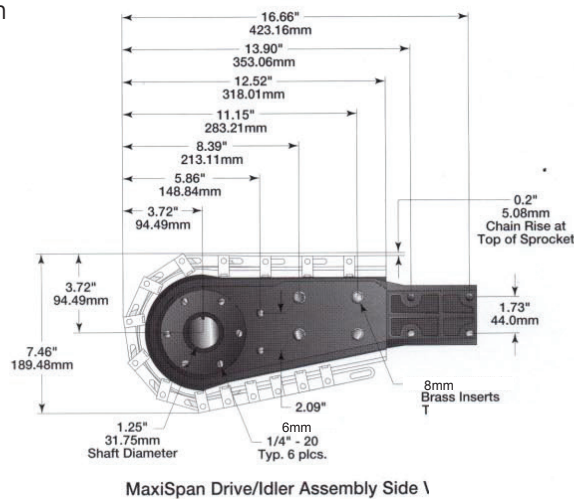

The illustrations shown represent typical space requirements and location dimensions of standard drive and idler assemblies for Span Tech conveyors.

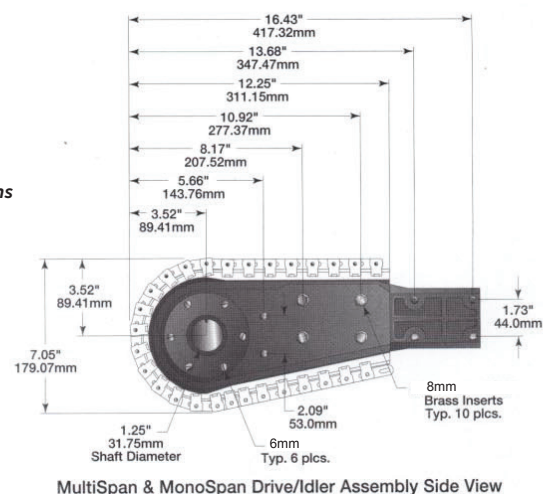

The information that has been provided are guidelines only. This does not represent all design variations possible. For detailed or specific design requirements please contact a representative or email info@spantechllc.com.

OUTRUNNER DRIVE

OutRunner Drives are typically used in continuous loop systems with top running chain only.

Accumulation

Outrunner Drives are the perfect solution for Endless Loop conveyors.



RULES OF THUMB FOR OUTRUNNER DRIVES

- Outrunner Drives power the conveyor chain from the side of the chain instead of chain wrapped around sprockets inside the conveyor.
- Outrunner Drives must be placed on an outside curve only. They are not suitable for straights or inside curves.
- Up to 2 Outrunner Drives can be used on a single conveyor using a single VFD. More than 2 Outrunner Drives require special controls.
- Combining Outrunner and Standard Drives can only be done with special controls which are available upon request.
- The Outrunner Drive can be configured to drive only the top chain (this is useful in making Endless Loop Conveyors) or the top and bottom chain in a standard conveyor with idlers on each end.

- Includes follower sprocket mechanism that will stop the drive if it is “tripped”. This is a safety mechanism to prevent things from getting pulled into the drive. Additionally, it will also stop the drive if a side link is missing.

NOTES:

The information that has been provided are guidelines only. This does not represent all design variations possible. For detailed or specific design requirements please contact a representative or email info@spantechllc.com.

GEARMOTORS

Torque - The measure of a force's tendency to produce a rotation about an axis (a turning or twisting force).

Horsepower - A unit of measurement of power (the rate at which work is done).

General Information:

SEW preferred Gearmotors. Span Tech uses WA, SA, and KA Gearmotors from SEW. They are wired for any country's electric standards.

SA Gearmotor:

- Slightly more expensive than the W series.
- Boasts an efficiency rating of around 85%.
- SA47 most common Gearmotor used.
- Offers hundred of reduction ratios.



KA Gearmotor:

- Most efficient & expensive gear box we use (94%-98%).
- Most robust Gearmotor SEW makes as it uses steel gearing.
- Designed to run constantly with high cycling rates with continuous load.



WA Gearmotor:

- Worm Gearmotor allows motor to handle shock loading, and constant starting and stopping.
- Least expensive and least efficient (around 60%).
- Because this is a smaller horse power motor, there are fewer gear ratios than S or K.

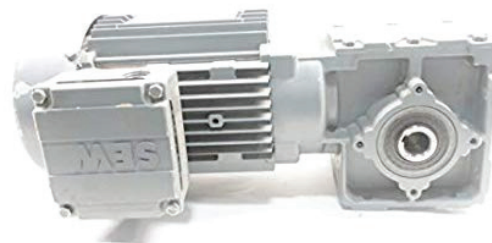

The information that has been provided are guidelines only. This does not represent all design variations possible. For detailed or specific design requirements please contact a representative or email info@spantechllc.com.

GEARMOTORS

BRAKE MOTORS

- To be used more as a “safety lock” to prevent the shaft from moving after it has already stopped.
- Not meant to stop the rotation of a shaft quickly.
- Acts like an e-brake not a brake pedal.



Z FAN

- Optional cast iron fan on gearmotors when the conveyor speed is over 120/fpm.
- Acts as a mechanical soft start and soft stop for the gearmotor.
- Reduces wear on the internal gears.

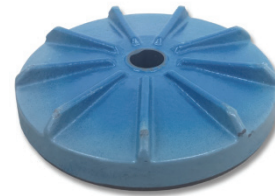

GEARMOTOR CONTROLS



Motor Starter:

- Glorified on/off switch



Variable Frequency Drive

- Can change speeds.
- Ramp ups and shutdowns.
- Change direction of the motor.
- Has overload protection.

The information that has been provided are guidelines only. This does not represent all design variations possible. For detailed or specific design requirements please contact a representative or email info@spantechllc.com.

CONVEYORS

[ADD ONS]

The information that has been provided are guidelines only. This does not represent all design variations possible. For detailed or specific design requirements please contact a representative or email info@spantechllc.com.

GUIDE RAIL

FEATURES:

- Used to guide product to a certain position on the conveyor. To align product with another conveyor, transfer or for automation.
- Used to stabilize tall product and keep them contained on the conveyor.
- Required when accumulating product to prevent products from “walking” off the conveyor and placed above the top of products to keep from popping up when in accumulation.

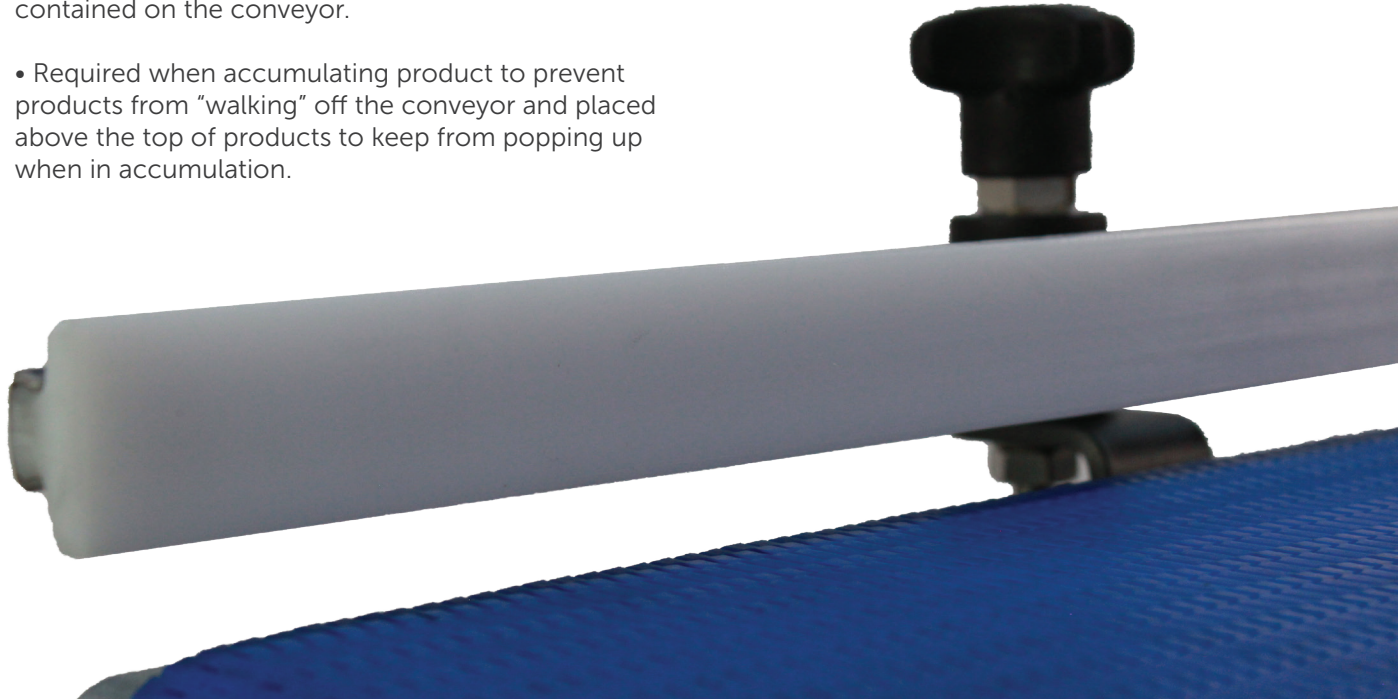

GUIDE RAIL BRACKET TYPES:

ValuGuide Adjustable (stainless or painted)

- Variable product sizes.
- Ability to adjust to an angle.
- Easy to adjust width but more difficult to adjust height. (spacers required)

Standard Adjustable (stainless or painted)

- Easy to adjust height and width.
- Limited width adjustments.
- Not as washdown friendly.

Fixed Channel Brackets (stainless or painted)

- Fixed product sizes.
- Fixed horizontal width.
- More cost effective than flat offset brackets.

Fixed Flat Offset Brackets (stainless or painted)

- Fixed product sizes.
- Horizontal offset can be tooled to wider widths.
- Higher cost bracket than channel brackets.

GUIDE RAIL TYPES:

Span Tech keeps an inventory in stock of three types of guide rails. Each rail is UHMW with a stainless-steel backing.

- 5/8" round rail
- 1 1/4" T-rail (flat profile)
- 2 1/4" T-rail (flat profile)

NOTES:

The information that has been provided are guidelines only. This does not represent all design variations possible. For detailed or specific design requirements please contact a representative or email info@spantechllc.com.

SIDEWALLS

FEATURES:

- Used to guard against the moving sides of the conveyor.
- Functions as a guide for products on the conveyor.

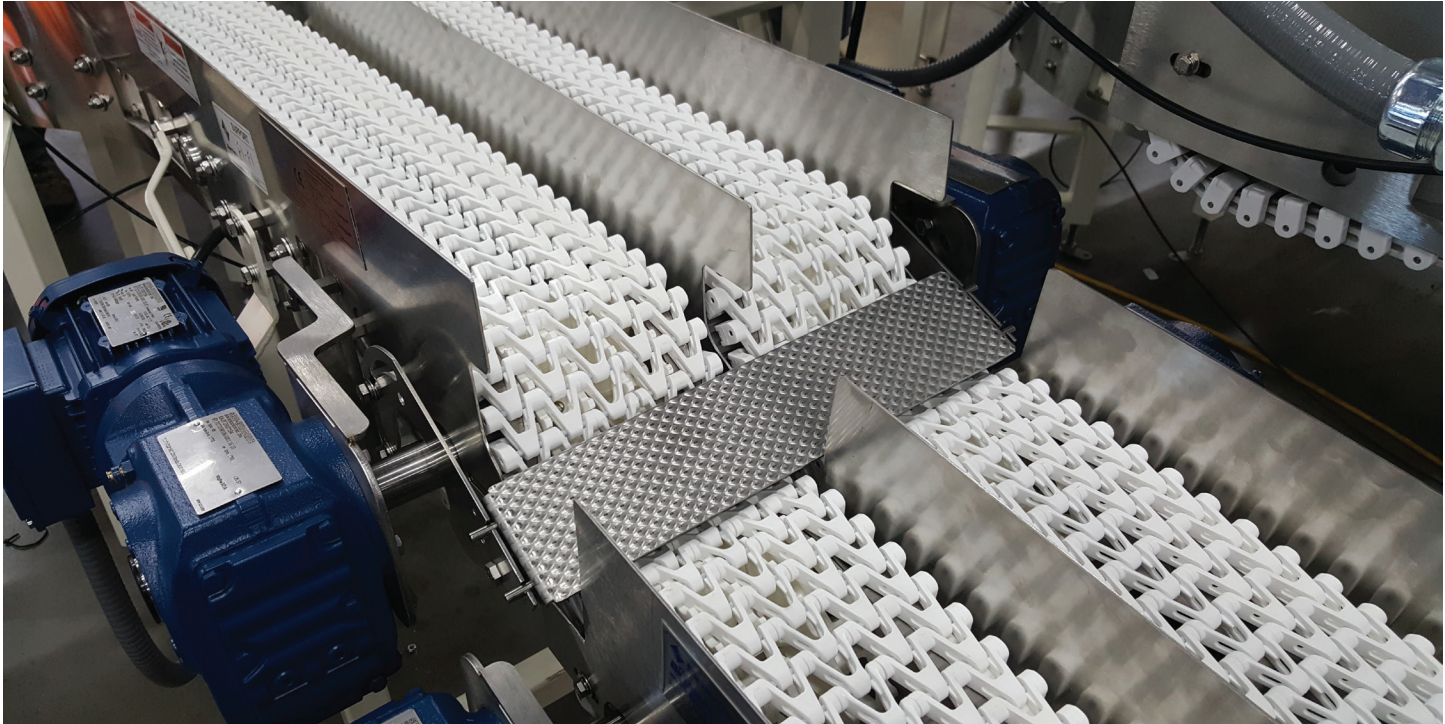

SIDE WALL TYPES:

Stainless Steel

- Higher cost.
- Most durable.

UHMW

- Most cost effective.
- Lower coefficient of friction.
- Will not scratch or crack.
- May expand or contract in varying temperatures.

Lexan

- Cost effective.
- Lighter weight.
- Can scratch and wear over time.
- Can crack if over-tightened.

NOTES:

The information that has been provided are guidelines only. This does not represent all design variations possible. For detailed or specific design requirements please contact a representative or email info@spantechllc.com.

TRAFFIC COP

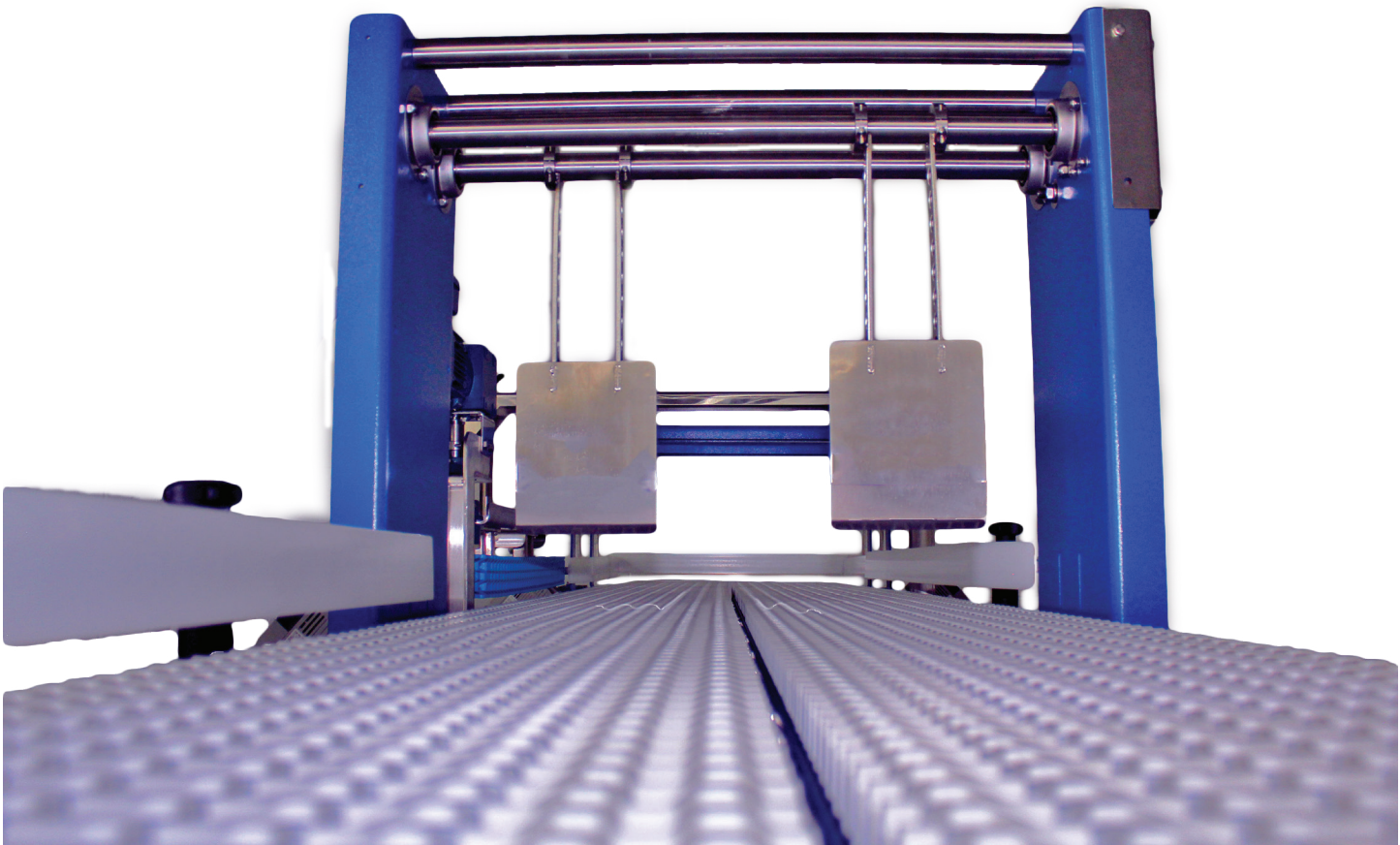

FEATURES:

- Designed as a pair of mechanically linked arms to orchestrate product flow for a smooth merge from two conveyor lanes to one lane of product, having uniform or non-uniform sizes and weights.
- Arms alternately hold back and then release the product, and are mechanically locked so that they cannot both release product at the same time.
- Using the mechanical design, operates without the use of sensing devices, I/O components, or powered automation.
- Works only on rigid products with the ability to accumulate.
- Low cost method for combining lanes.

NOTES:

The information that has been provided are guidelines only. This does not represent all design variations possible. For detailed or specific design requirements please contact a representative or email info@spantechllc.com.

BUMP ROTATE

FEATURES:

- Intentional obstruction in the path of the product on a conveyor which causes the product to rotate and change orientation 90°.
- Two Bump Rotates can be used to rotate the product 180 °.
- Mechanical design operates without the used of sensing devices, I/O components, or powered automation.
- Generally requires guide rail after the Bump Rotate to straighten the product.
- Temporarily slows the product down on the conveyor which is why a minimum [pitch rule \(see below\)](#) must be followed.

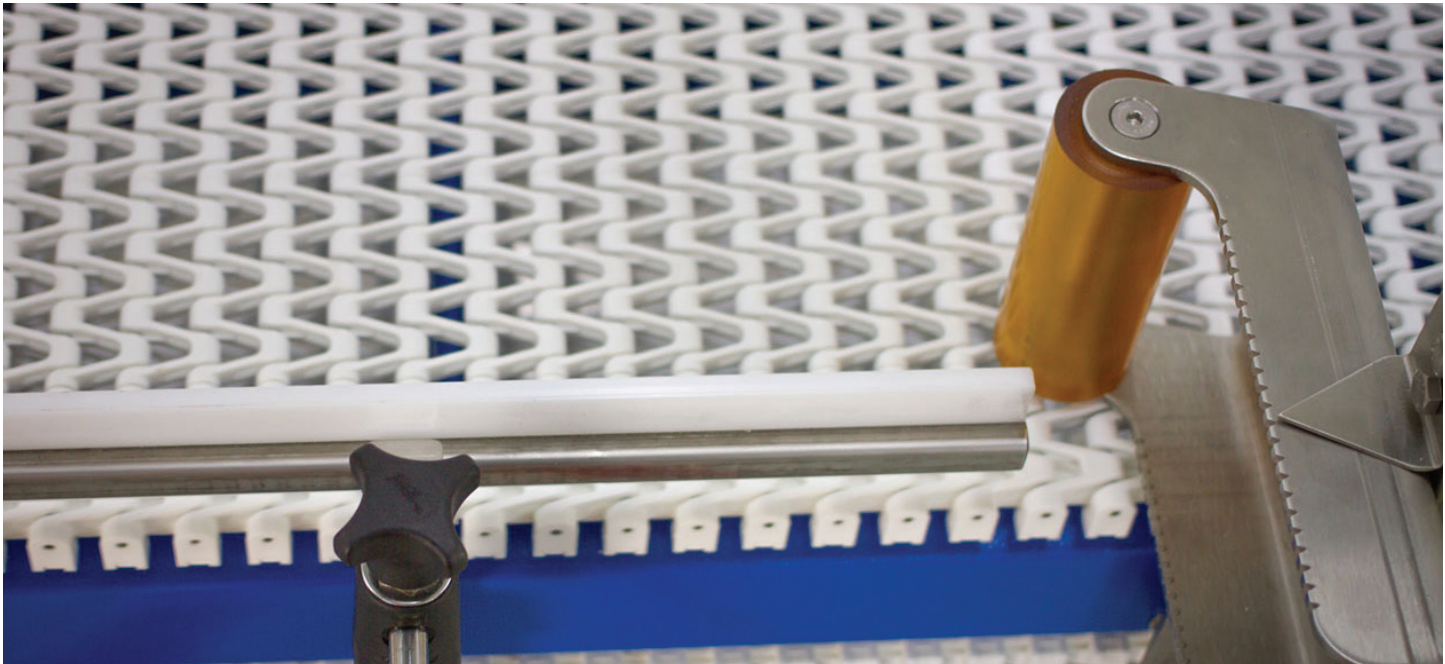

PITCH RULES:

Roller Chain $V = (W \times 3.2) \times R$

- V = Conveyor Speed (fpm)
- W = Incoming Product Dimension (ft.)
- R = Max production rate (products per meter)

**an acceleration zone or metering stop may be necessary to achieve the correct product spacing.*

High Friction Chain $V = (W \times 2.0) \times R$

- V = Conveyor Speed (fpm)
- W = Incoming Product Dimension (ft.)
- R = Max production rate (products per meter)

NOTES:

The information that has been provided are guidelines only. This does not represent all design variations possible. For detailed or specific design requirements please contact a representative or email info@spantechllc.com.

METAL DETECTOR SECTIONS

FEATURES:

- Conveyor section designed to use with customer supplied metal detectors.
- Conveyors designed with MaxiSpan or MonoSpan chain types.
- Generally, uses a separate conveyor with additional infeed and discharge conveyors due to the limitations of the MaxiSpan or MonoSpan conveyor chains.

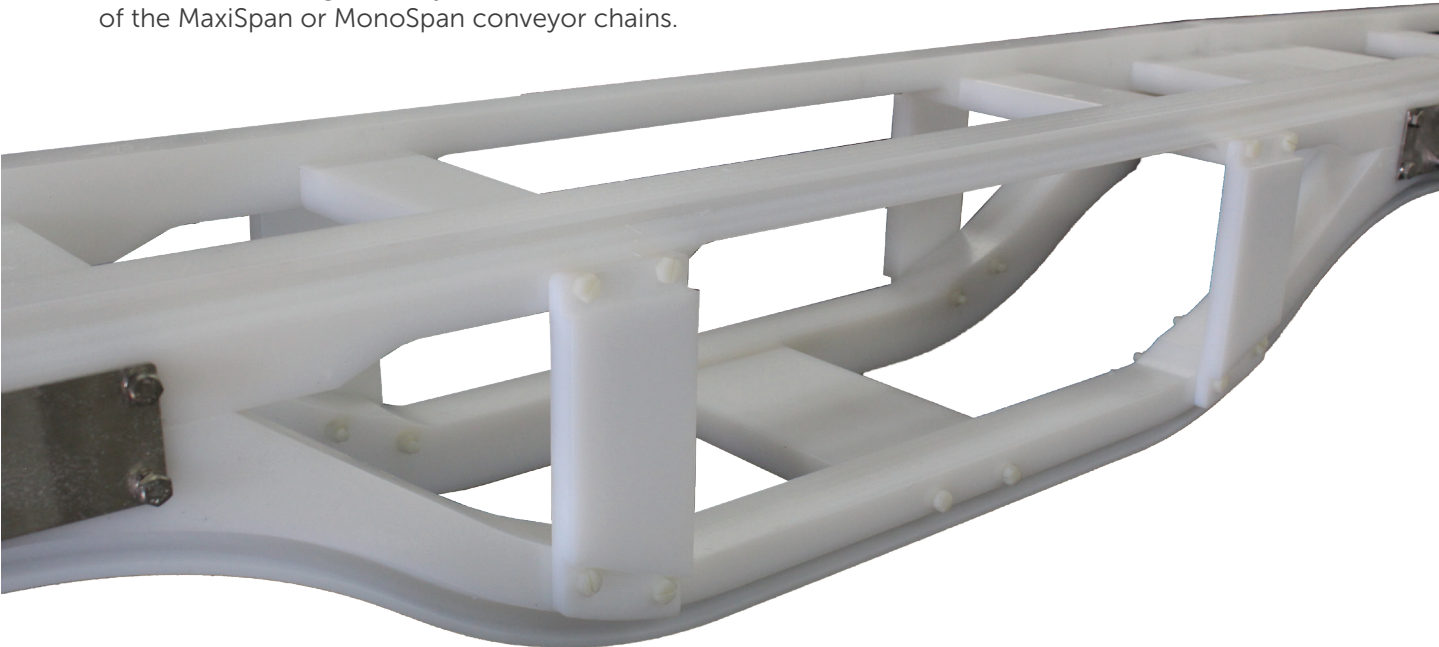

TYPES OF METAL DETECTOR SECTIONS:

Low Profile Metal Detector Sections

- More cost effective.
- Both top and bottom chain pass through the metal detector.
- Requires larger clearance area in metal detector since both top and bottom chain pass through metal detection area.

Split Bed Metal Detector Sections

- Higher Cost.
- Only top layer of chain passes through metal detector.
- Smaller clearance area since only the top chain passes through the metal detector area.

NOTES:

The information that has been provided are guidelines only. This does not represent all design variations possible. For detailed or specific design requirements please contact a representative or email info@spantechllc.com.

VARIABLE FREQUENCY DRIVE

FEATURES:

- Controlled start/stop (for smooth acceleration/ deceleration of the motor).
- Automatic or manual changes to the speed of the motor while its running.
- Ability to reverse the direction of the motor.
- Loss of torque will happen above and below 60 Hz.
- Overload protection.
- Feedback for how much voltage/amps the motor is using while its running.
- Can be controlled via external devices (PLC).
- VFD's are sized according to the amount of power they will need to supply to the electromechanical device they are powering.



VINYL UNDER GUARDING

FEATURES:

- A yellow vinyl cloth connected to the conveyor with stainless still brackets.

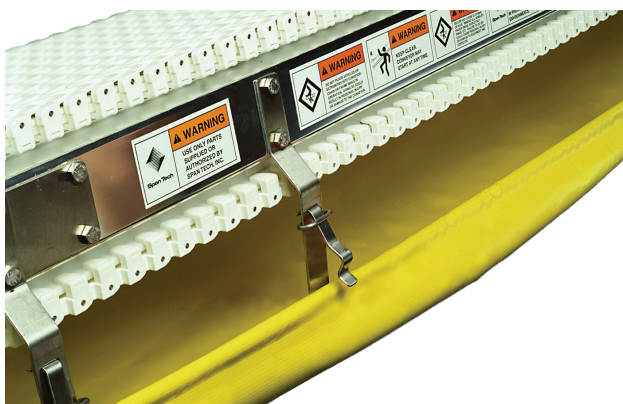

NOTES:

The information that has been provided are guidelines only. This does not represent all design variations possible. For detailed or specific design requirements please contact a representative or email info@spantechllc.com.

CLEAN OUT HOLES

Clean Out Holes are used when sanitation is a very high priority. They allow for better access to the inside of the conveyor bed for effectiveness and less time consuming washdown.



CLEAN OUT HOLE OPTIONS:

- **ROUND HOLES**– Ø 2 1/8" clean-out holes, located on 3 7/16" centers, included in the straight frame sections only and dependent on bed section length.
- **SLOTTED HOLES**– 4 3/8" long clean-out holes, located on 2.719" centers, included in the straight frame sections only and dependent on bed section length.

DRIP TRAYS

Drip Trays are designed to catch liquids and debris that could fall off the conveyor, and drip trays are custom designed for each individual conveyor.

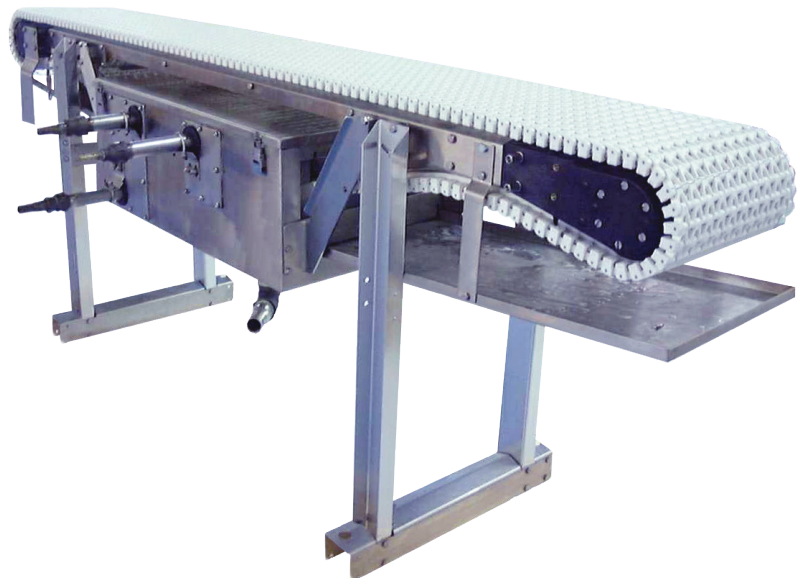

CHAIN WASHER

The chain washer section is approximately 5' long and bolts directly to the conveyor bed section in a straight, horizontal section. The chain washer is designed to wash the lower return chain. The washer uses a spray manifold to wash the chain and air knives and brushes to remove most of the water from the chain. The customer will be responsible for plumbing water and air supply to the unit and the drain from the unit.

NOTES:

The information that has been provided are guidelines only. This does not represent all design variations possible. For detailed or specific design requirements please contact a representative or email info@spantechllc.com.

LOW PROFILE IDLER

FEATURES:

- Low Profile Idlers slim design can eliminate the need for transfer devices at the conveyor infeed or discharge.
- Moves product as small as 4.5" without stalling or using a transfer bridge.
- Existing conveyors can be directly retrofitted with the Low Profile Idler. If your product changes, your conveyors can change with it.

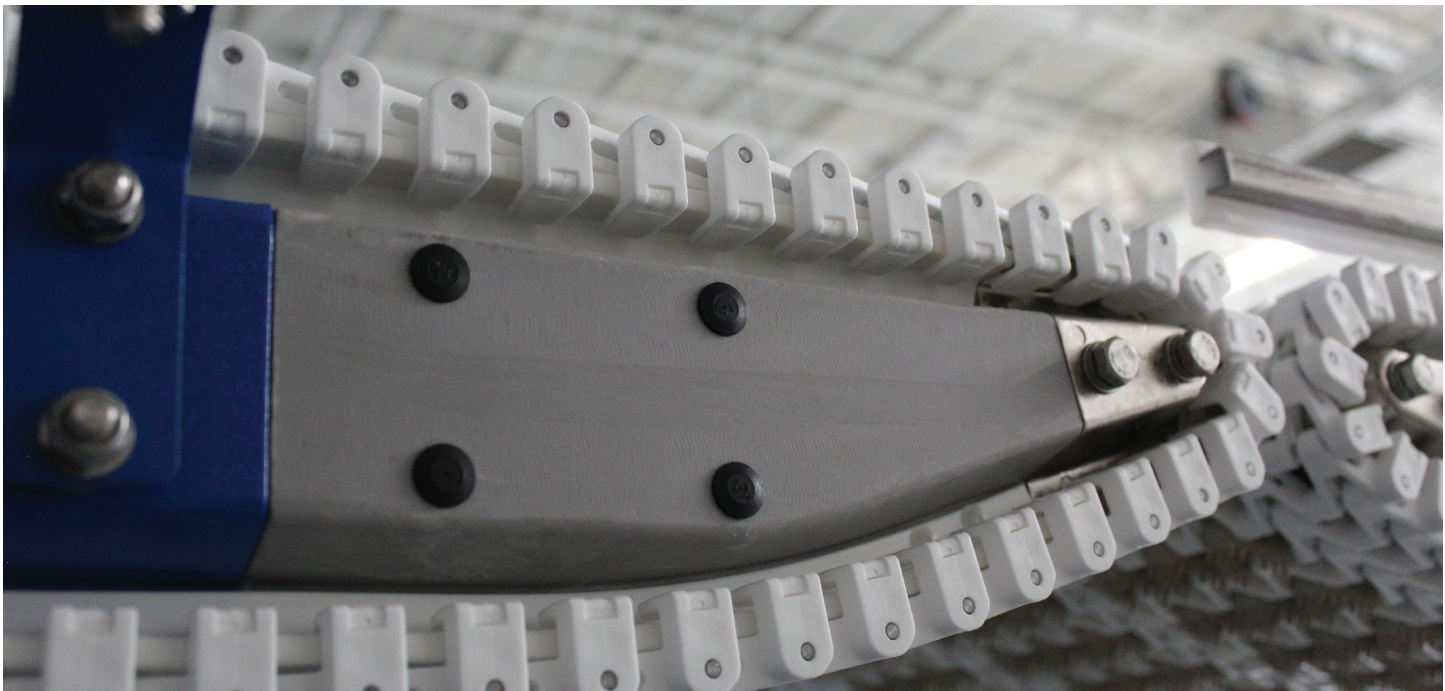

RULES OF THUMB FOR LOW PROFILE IDLERS

- The Low Profile Idler is the same length as the standard idler unit and they are interchangeable.
- The Low Profile Idler has a 3.4" nose diameter.
- Low Profile Gravity Roller Transfers are used in conjunction with Low Profile Idlers (2, 3, or 4 rollers).
- 50mm MultiSpan, MaxiSpan and MonoSpan chains are not compatible with Low Profile Idlers.
- Low Profile Idlers should not be used with Closed Top chain over 25.02" wide.

NOTES:

The information that has been provided are guidelines only. This does not represent all design variations possible. For detailed or specific design requirements please contact a representative or email info@spantechllc.com.

LANE DIVIDERS

- Suspended from above the conveyor in order to create multiple rows for products on the same conveyor.
- Used to separate rows of small product on a single conveyor.
- Made of sidewall or guiderail.
- Made to be fixed or adjustable for straight sections only.



LEXAN SAFETY GUARDING

Lexan guarding is an option for certain applications where safety could be a concern. The High Speed Switch is an area where contact with the conveyor could result in injury. Lexan guarding covers the conveyor where parts are moving at very high speeds to ensure the safety of the members who station it. It ultimately blocks unintentional direct contact with the conveyor resulting in minimal opportunity for injury*.

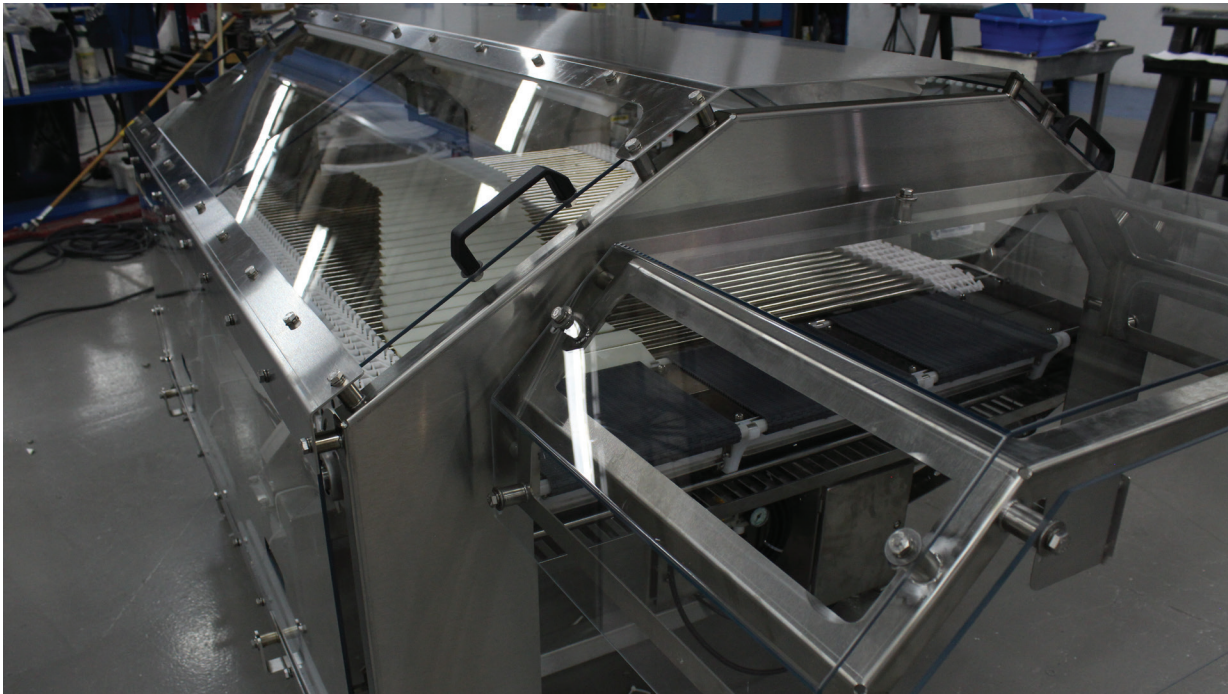

**The safety of any conveyor system is ultimately the responsibility of the end user. The lexan guarding provided, while very sturdy and capable of offering adequate protection from moving parts, does not follow a specific guarding or OSHA guideline.*

The information that has been provided are guidelines only. This does not represent all design variations possible. For detailed or specific design requirements please contact a representative or email info@spantechllc.com.

CONVEYORS [TRANSFERS]

The information that has been provided are guidelines only. This does not represent all design variations possible. For detailed or specific design requirements please contact a representative or email info@spantechllc.com.

HORIZONTAL BALLISTIC TRANSFER

Horizontal ballistic transfers are the most basic of transfers that Span Tech offers. They are the most cost efficient of all the SpanTech transfers because no additional hardware is needed. Products are transferred from one conveyor to the next. These transfers are flat with no elevation changes.

PRODUCT REQUIREMENTS FOR ALL

- Small products may be possible depending on product characteristics and conveyor speed.
- Product should be stable.
- These methods are not suitable for products small enough to dip into the gap between conveyors.

HORIZONTAL STANDARD TO STANDARD BALLISTIC TRANSFER

The product is transferred from a standard drive to a standard idler.

- Small products may be possible depending on product characteristics and conveyor speed.
- Product should be stable.
- These methods are not suitable for products small enough to dip into the gap between conveyors.

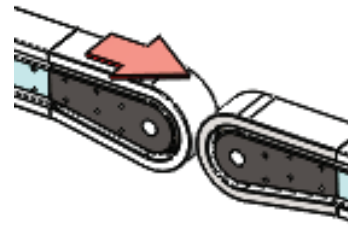

HORIZONTAL STANDARD TO LOW PROFILE BALLISTIC TRANSFER

The smaller radius of the low-profile design provides a shorter transfer gap. This transfer has a slightly higher cost due to the use of the low-profile idler.

- Products as small as seven inches (177.8 mm) may be possible depending on product characteristics and conveyor speed.
- When using a low-profile idler, conveyor speed in general is limited to 150 feet per minute (45.72 mpm).

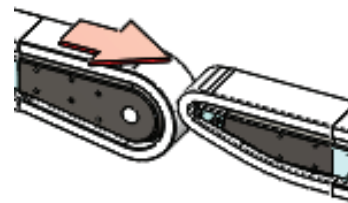

HORIZONTAL LOW PROFILE TO LOW PROFILE BALLISTIC TRANSFER

With both conveyors having the low profile design, this technique provides the shortest ballistic transfer gap and can therefore handle the smallest product of any ballistic transfer configuration. This transfer has a slightly higher cost due to the use of the low profile idler.

- Products as small as six inches (152.4 mm) may be transferred.
- When using a low profile idler, conveyor speed in general is limited to 150 fpm (45-72 mpm).

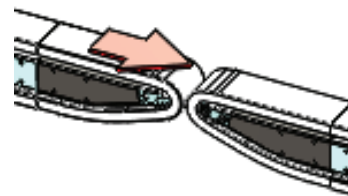

The information that has been provided are guidelines only. This does not represent all design variations possible. For detailed or specific design requirements please contact a representative or email info@spantechllc.com.

OFFSET BALLISTIC TRANSFER

Another method of product transfer is known as an offset transfer (also called a waterfall transfer). An offset transfer occurs when a product is dropped from the end of one conveyor onto a second conveyor, positioned at a lower elevation. This method is usually used for bulk product flow or product in bags. An offset transfer adds no cost, but can cause the product to tumble during the transfer. Products may also lose orientation during transfer and guide rails or moving side guides may be required.

PRODUCT REQUIREMENTS FOR ALL

- Small Products may be possible, depending on product characteristics and conveyor speed..

OFFSET STANDARD TO STANDARD BALLISTIC TRANSFER

The product is transferred from a standard drive to a standard idler.

- Products with a minimum length of 8.5 inches (215.9 mm).

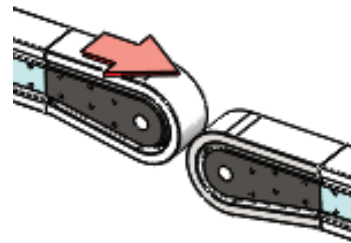

OFFSET STANDARD TO LOW PROFILE BALLISTIC TRANSFER

The smaller radius of the low profile design provides a shorter transfer gap. This transfer has a slightly higher cost due to the use of the low profile idler.

- Products as small as 7.5" (177.8 mm) may be transferred.
- When using a low profile idler, conveyor speed in general is limited to 150 feet per minute (45.72 mpm).

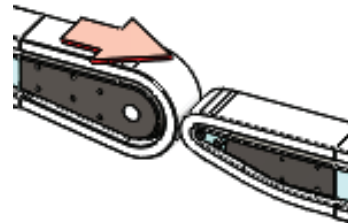

OFFSET LOW PROFILE TO LOW PROFILE BALLISTIC TRANSFER

The low profile to low profile offset ballistic transfer offers the shortest transfer distance possible without the use of a transfer device.

- Products as small as 5.75" (146.05 mm) may be transferred.
- When using a low profile idler, conveyor speed in general is limited to 150 fpm (45.72 mpm).
- Smallest transfer distance without using a device.

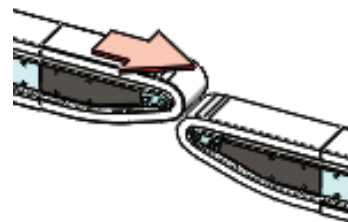

The information that has been provided are guidelines only. This does not represent all design variations possible. For detailed or specific design requirements please contact a representative or email info@spantechllc.com.

DEAD PLATE TRANSFER

A dead plate transfer uses a flat piece of stainless steel or UHMW to bridge the gap between conveyors. As with all Span Tech transfers, the dead plate transfer incorporates a lift-out design – an important safety feature in the event that anything becomes caught between the transfer and conveyor.

PRODUCT REQUIREMENTS FOR BOTH

- Smaller products are possible at speeds of 120 feet per minute (36.576 mpm) and higher
- Raw or sticky material is likely to stall on a dead plate transfer.
- This method can only be used in applications where the conveyor runs fast enough to reliably propel the product across the unpowered transfer bridge.
- Transfer is not suitable for most bagged products as their flaps or seams could get caught in the transfer
- Designed with a safety lift-out feature.

HORIZONTAL STANDARD TO STANDARD DEAD PLATE TRANSFER

- Products as small as 8.5" (215.9 mm) can be transferred at any speed.
- Best suited for higher-speed conveyors carrying larger, rigid products.

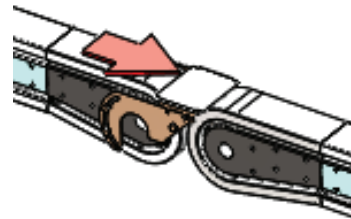

OFFSET STANDARD TO STANDARD DEAD PLATE TRANSFER

The offset dead plate transfer is similar to an offset transfer. Due to the downhill angle of the plate, the offset dead plate transfer can work with conveyor speeds slower than those compatible with the standard dead plate. Like the offset ballistic transfer, the offset dead plate may cause products to tumble, and therefore may require the use of guide rails for some applications.

- Products as small as 8.5" (215.9 mm) can be transferred at any speed.
- Best suited for higher-speed conveyors carrying larger, rigid products.

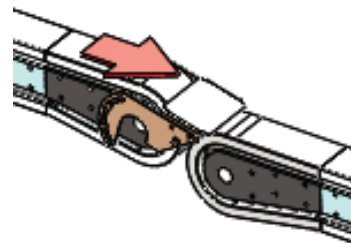

The information that has been provided are guidelines only. This does not represent all design variations possible. For detailed or specific design requirements please contact a representative or email info@spantechllc.com.

FINGERS TRANSFER

Between the conveyor and transfer there is a small gap which could cause problems with transferring smaller products. One way to reduce this gap is to use fingers (in combination with raised chain). Fingers are made from molded plastic and are designed to sit in between the raised rows of the conveyor chain. These fingers act as a very small dead plate transfer with the added advantage that there is no leading edge for the product to catch on.

Fingers can be used with plain chain, but this is considered a special application and is typically not necessary for most applications.

Fingers are available for Standard Drive/Idler units with Gravity Roller, MicroSpan, and Wire Mesh transfers.

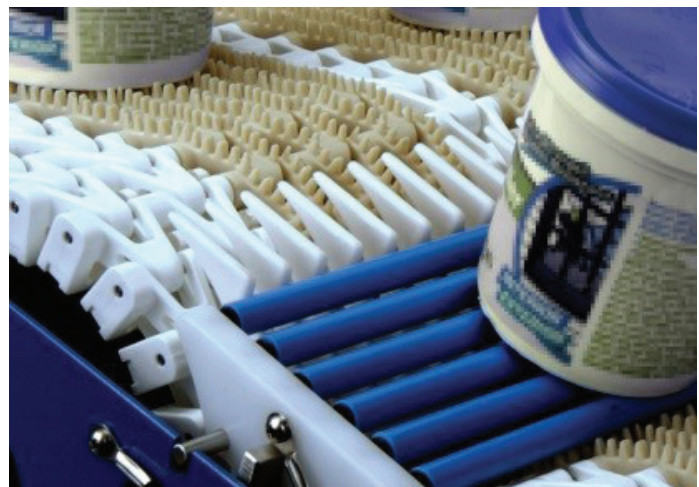
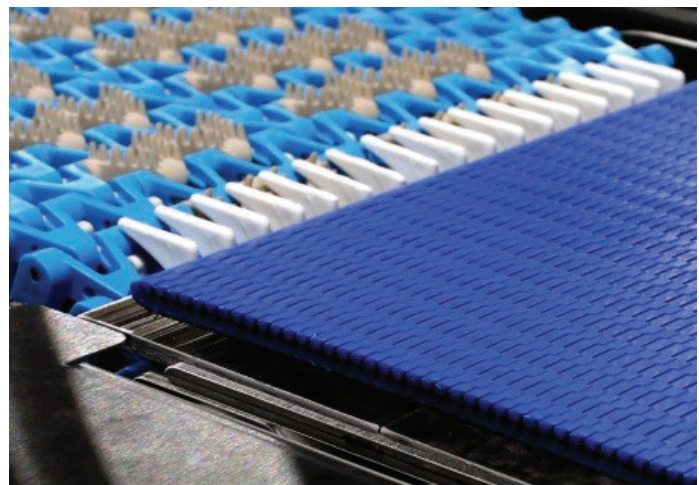
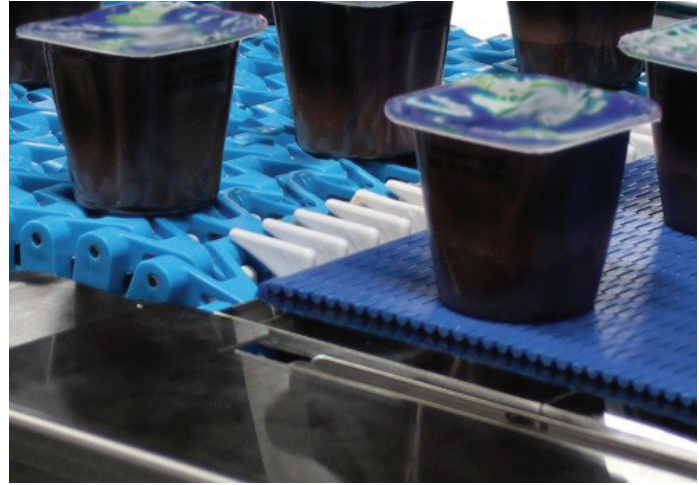

The information that has been provided are guidelines only. This does not represent all design variations possible. For detailed or specific design requirements please contact a representative or email info@spantechllc.com.

THANK YOU

FOLLOW US ON SOCIAL MEDIA AND KEEP UP WITH ALL OF OUR INNOVATIVE SOLUTIONS



The information that has been provided are guidelines only. This does not represent all design variations possible. For detailed or specific design requirements please contact a representative or email info@spantechllc.com.